

Sweet Template Help:





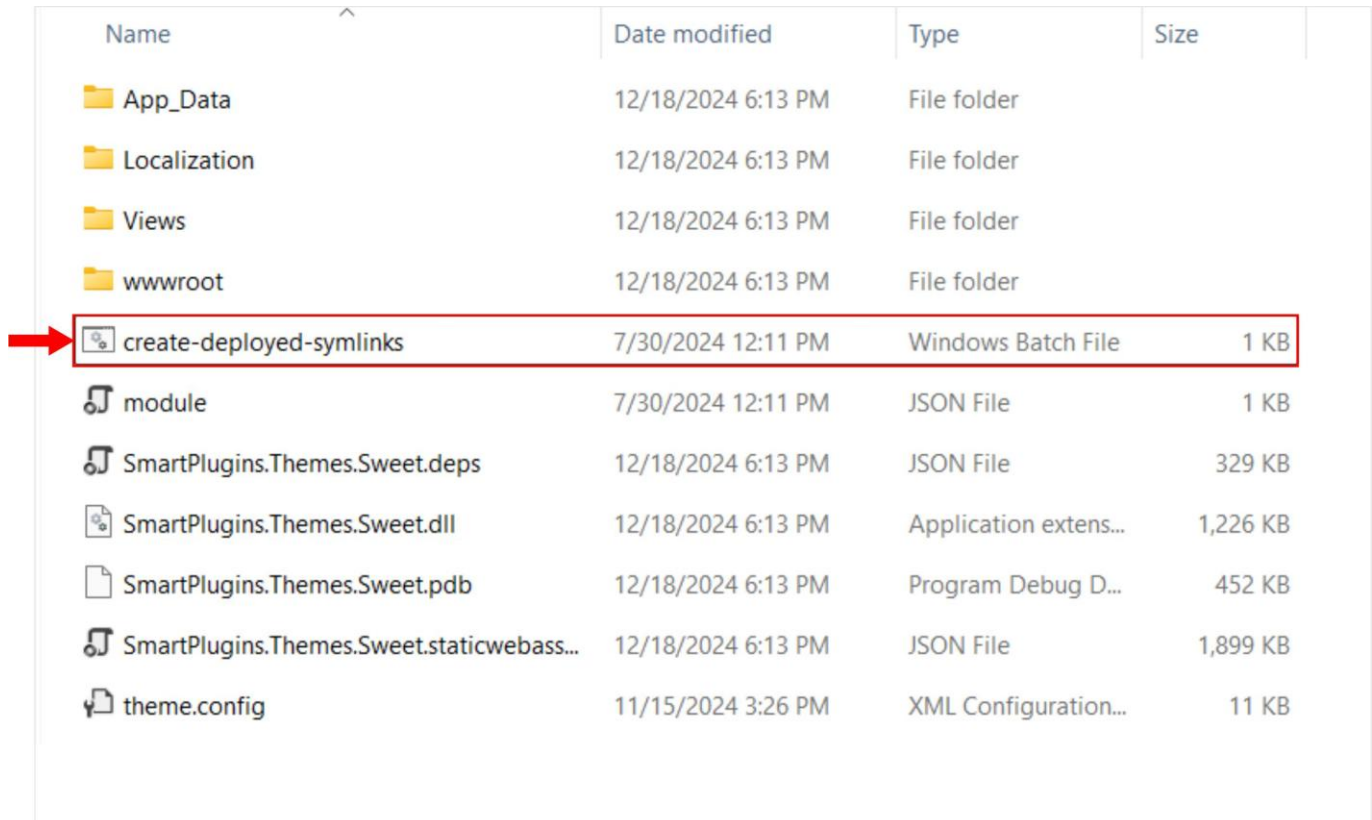

The file you see is the configuration and usage guide for the Sweet template module. This document aims to explain the steps in a simple and clear manner, with pictures.

Please follow along with us:

After installing the template module Sweet, go to the "Modules" folder and then enter "SmartPlugins.Themes.Sweet" folder.

Then run the "create-deployed-symlinks" file.



| Name | Date modified | Type | Size |
|---|--------------------|-----------------------|----------|
| App_Data | 12/18/2024 6:13 PM | File folder | |
| Localization | 12/18/2024 6:13 PM | File folder | |
| Views | 12/18/2024 6:13 PM | File folder | |
| wwwroot | 12/18/2024 6:13 PM | File folder | |
|  create-deployed-symlinks | 7/30/2024 12:11 PM | Windows Batch File | 1 KB |
|  module | 7/30/2024 12:11 PM | JSON File | 1 KB |
|  SmartPlugins.Themes.Sweet.deps | 12/18/2024 6:13 PM | JSON File | 329 KB |
|  SmartPlugins.Themes.Sweet.dll | 12/18/2024 6:13 PM | Application extens... | 1,226 KB |
|  SmartPlugins.Themes.Sweet.pdb | 12/18/2024 6:13 PM | Program Debug D... | 452 KB |
|  SmartPlugins.Themes.Sweet.staticwebass... | 12/18/2024 6:13 PM | JSON File | 1,899 KB |
|  theme.config | 11/15/2024 3:26 PM | XML Configuration... | 11 KB |

After running this file, the Sweet folder will be automatically created in the theme folder.

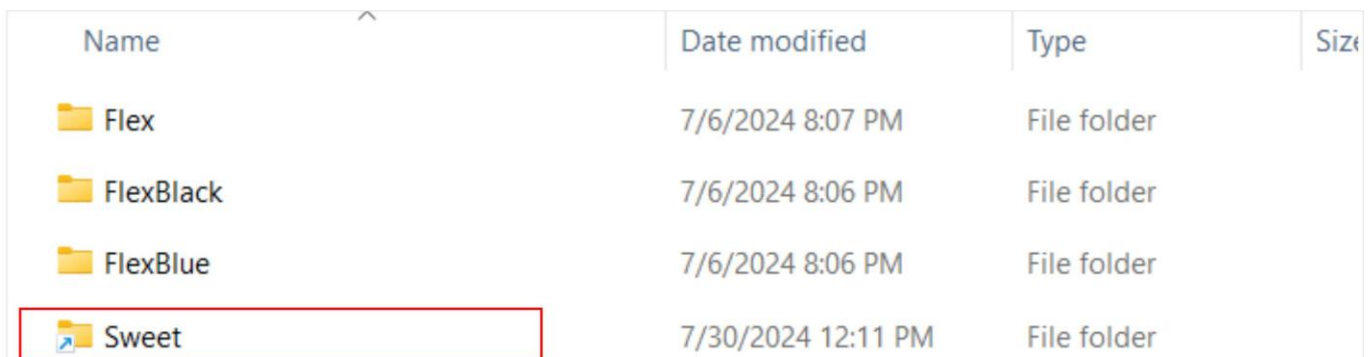

| Name | Date modified | Type | Size |
|---|--------------------|-------------|------|
| Flex | 7/6/2024 8:07 PM | File folder | |
| FlexBlack | 7/6/2024 8:06 PM | File folder | |
| FlexBlue | 7/6/2024 8:06 PM | File folder | |
|  Sweet | 7/30/2024 12:11 PM | File folder | |

Then go to the admin panel and proceed as shown in the image:

Smartstore Dashboard Overview

Navigation: Dashboard, Catalog, Sales, Customers, Promotions, CMS, Configuration, System, Plugins

Summary Cards: Incomplete orders (Today: \$0.00, Last 7 days: \$0.00, This year: \$0.00)

Newsfeed: Smartstore 6 Release Highlights

Configuration Menu: Settings, Stores, Regional Settings, Payment methods, Lists, Email Accounts, Activity Types, Import, Export, **Themes**

Orders: \$0.00

Time Periods: Today, Yesterday, Last 7 days, Last 28 days, This year

Smartstore Themes Management

Store: market

Buttons: Save, Reload themes, Upload theme

Installed themes:

- Flex (Active)
- Flex Blue (Activate)
- Flex Black (Activate)

Smartstore Themes Management

Store: Your store name

Buttons: Save, Reload themes, Upload theme

Installed themes:

- Flex (Active)
- Flex Black (Activate)
- Flex Blue (Activate)
- Sweet (Activate)**

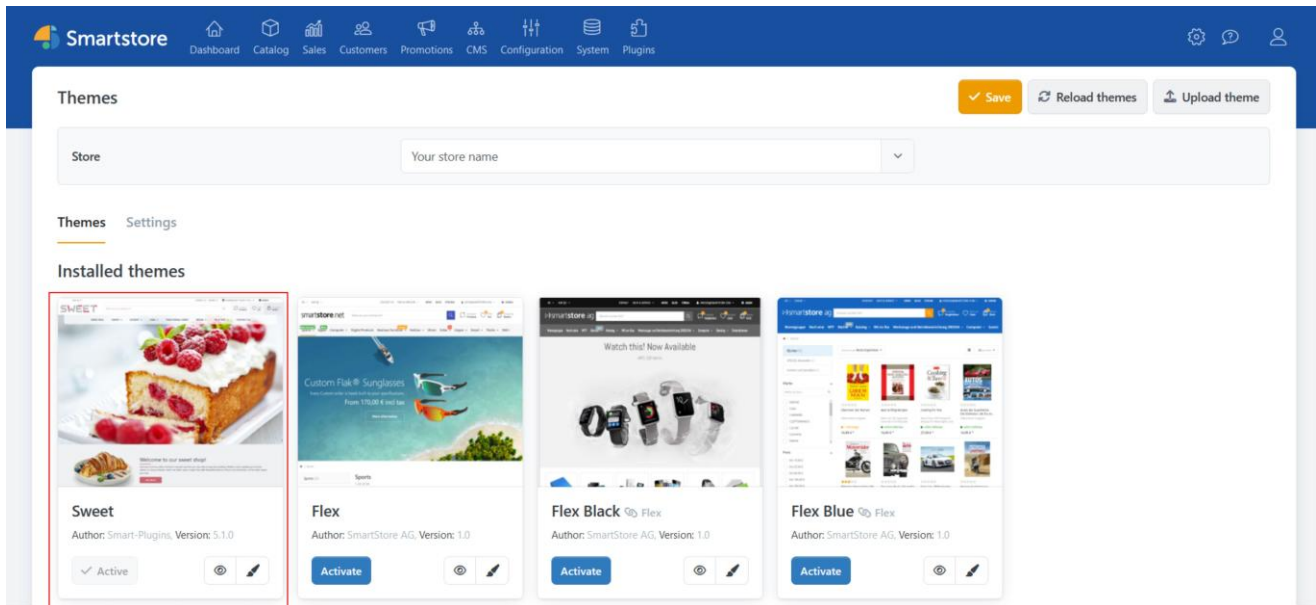

Now, follow the images below for active widgets and using the modules:

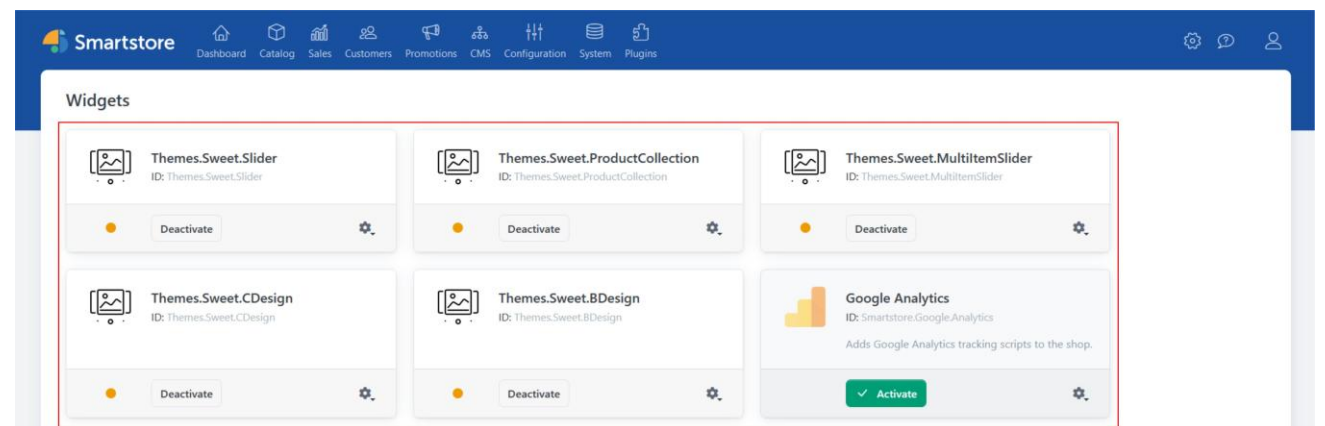
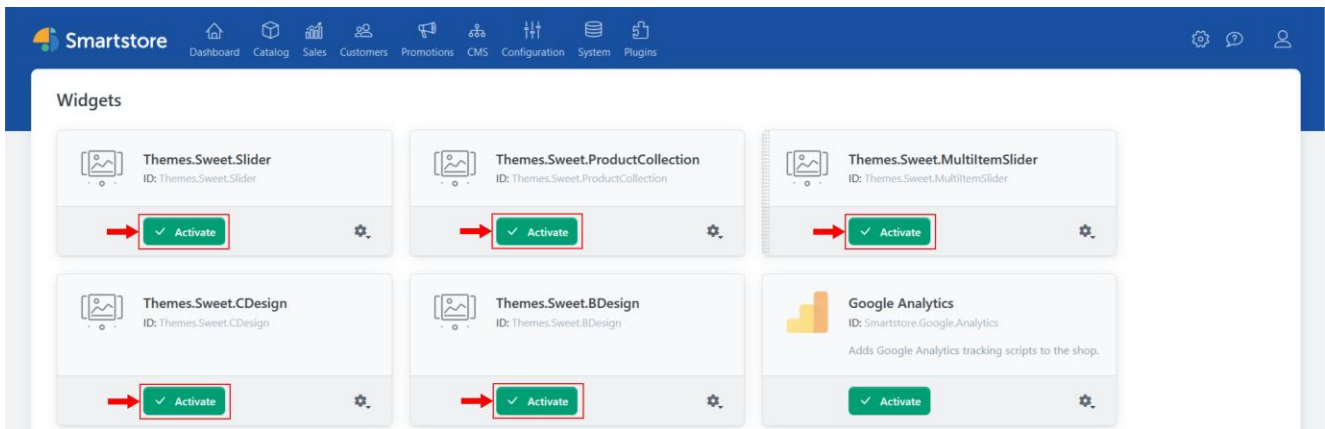
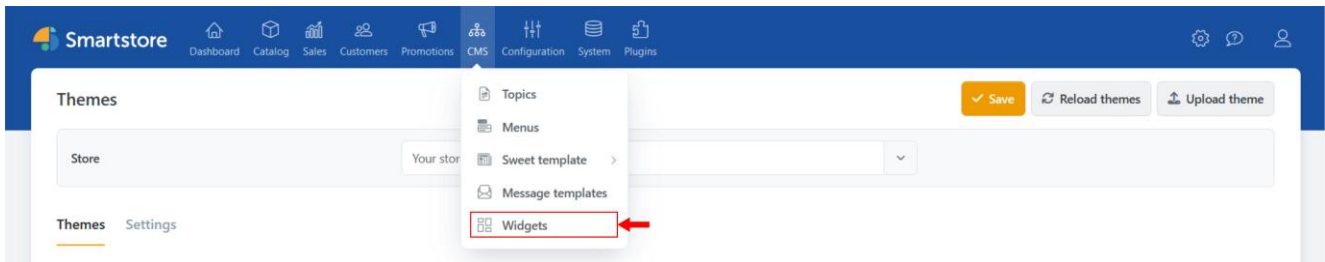

Now that the template is installed and all the modules are ready, you need to add your information to the template. In the image below, all the sections of the template we have prepared are highlighted separately.

For an explanation of each section, refer to the corresponding section:

The image shows a screenshot of a website template for a bakery named 'SWEET'. The page is divided into several sections, each highlighted with a red box and a red arrow pointing to a numbered label on the right. The sections are as follows:

- 1. Logo:** Points to the 'SWEET' logo in the top left corner.
- 2. Menu:** Points to the horizontal navigation menu at the top, including links like HOME PAGE, CANDY, DESSERT, CAKE, etc.
- 3. Menu Plus:** Points to a sub-menu area showing categories like Cookies and Cupcake.
- 4. Slider (1):** Points to a large image slider featuring a raspberry cake.
- 5. Multi Item Slider (1):** Points to a section with a 'Welcome to our sweet shop!' message and a 'See More' button.
- 6. Category Design:** Points to a row of six category icons: CANDY, DESSERT, CAKE, TRADITIONAL SWEET, BREAD, and PIE & TART.
- 7. Slider (2):** Points to a slider showing five colorful cupcakes with sparklers.
- 8. Product:** Points to a grid of featured products with images, names, and prices.
- 9. Multi Item Slider (2):** Points to a section titled 'The perfect treat for your afternoon!' with a 'See More' button and an image of a pie.
- 10. Slider (3):** Points to a slider showing various sweets like candies, a chocolate cake, and pies.
- 11. Multi Item Slider (3):** Points to a section with four columns of product benefits: Appropriate Packaging, High-Quality Ingredients, Variety of products, and Freshness of Products.
- 12. Recently Viewed Product:** Points to a row of six product cards from the featured products section.
- 13. Social Media:** Points to a social media sharing bar at the bottom of the page.

1. logo:

In this section, you can upload your desired logo. The logo dimensions can be approximately as follows: a width of around 300 pixels and a height of around 80 pixels.

Follow these steps the Admin Panel to add your personal logo:

The first screenshot shows the Smartstore Admin Panel dashboard. A red box highlights the 'Stores' option in the 'Settings' menu, with a red arrow pointing to it labeled '1'. The dashboard includes sections for 'Incomplete orders' with circular progress indicators for 'Today', 'Last 7 days', and 'This year', all showing '\$0.00'. A 'Newsfeed' section on the right highlights 'Smartstore 6'.

The second screenshot shows the 'Stores' management page. A table lists store details. A red box highlights the 'sweet' store name, with a red arrow pointing to it labeled '2'. The table has columns for Store name, Shop URL, HOST values, Content Delivery Net..., Require HTTPS, and Display order.

| Store name | Shop URL | HOST values | Content Delivery Net... | Require HTTPS | Display order ↑ |
|------------|---------------------------------|------------------------------------|-------------------------|---------------|-----------------|
| sweet | http://sweet.smart-plugins.com/ | yourstore.com www.yourstore.com | | — | 1 |

The third screenshot shows the 'Edit store details' page. A red box highlights the 'Store logo' field, which contains a placeholder image of a logo with the text 'SWEET logo.png'. A red arrow points to it with the text '3. Drag your logo here'. At the top right, a red box highlights the 'Save' button, with a red arrow pointing to it labeled '4'. Other buttons include 'Save and Continue Edit' and 'Delete'.

2. Menu:

To add a category and its subcategories, use the link below:

<https://smartstore.atlassian.net/wiki/spaces/SMNET50/pages/1956119658/Organizing+Product+Categories>

3. Menu Plus:

"Menu Plus" can be activated whether you have already created a category or intend to create a new one. To activate **Menu Plus**, follow these steps:

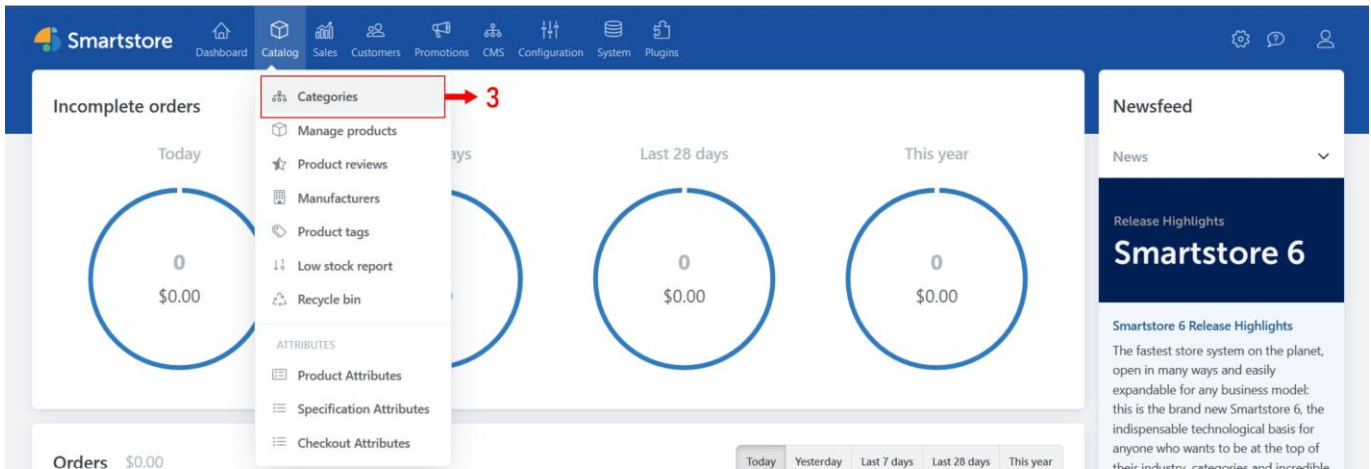
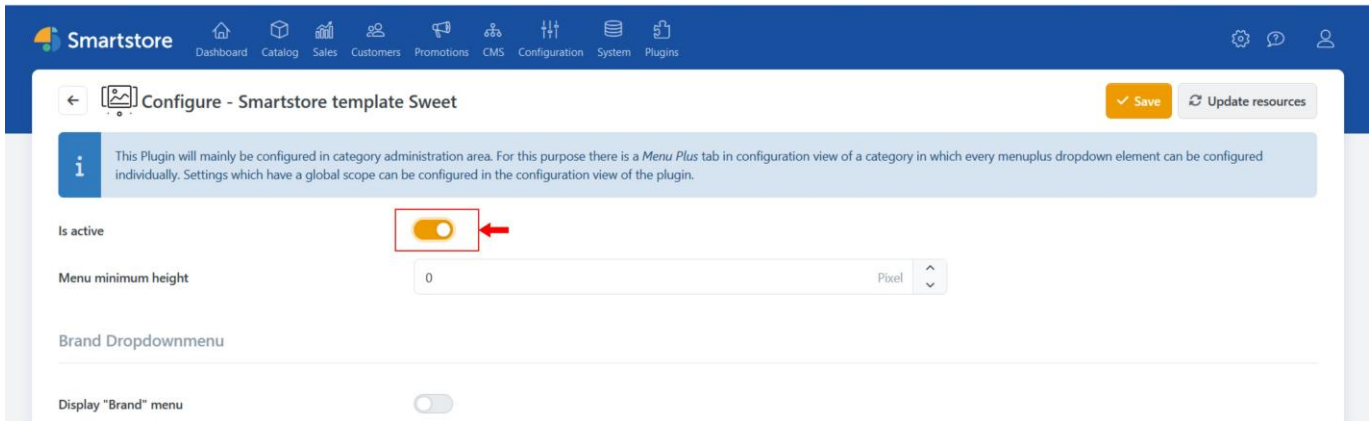
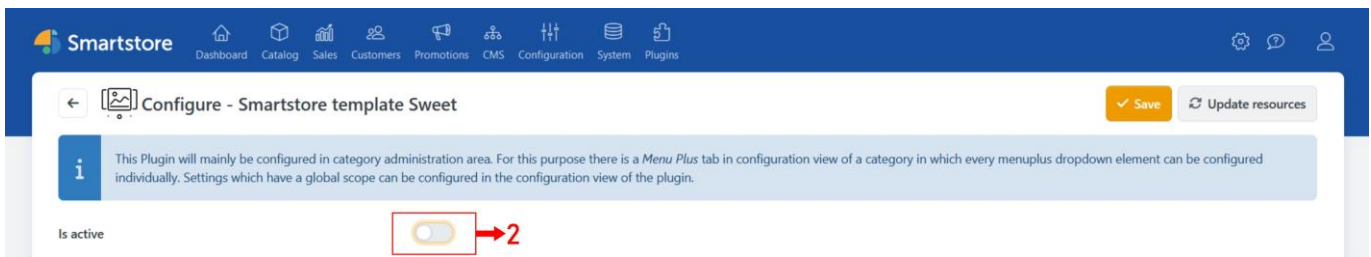
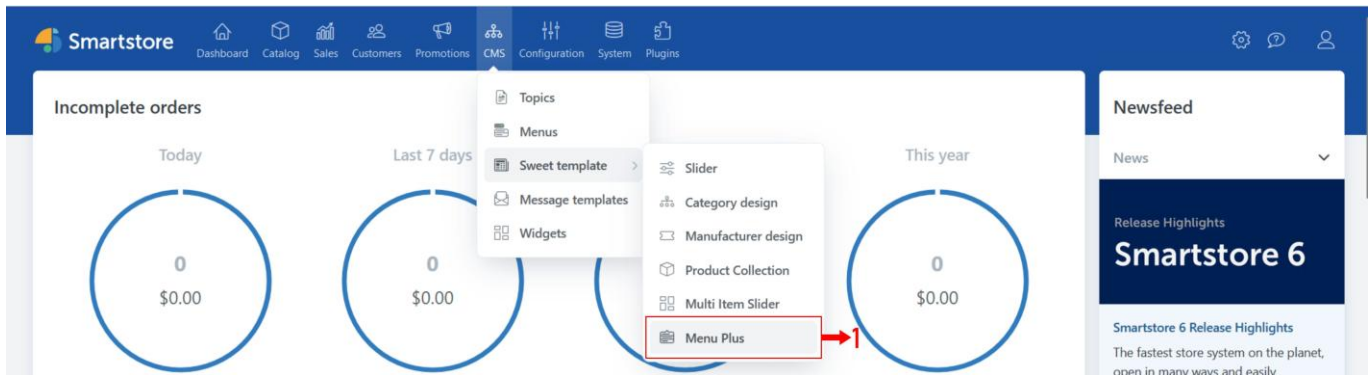

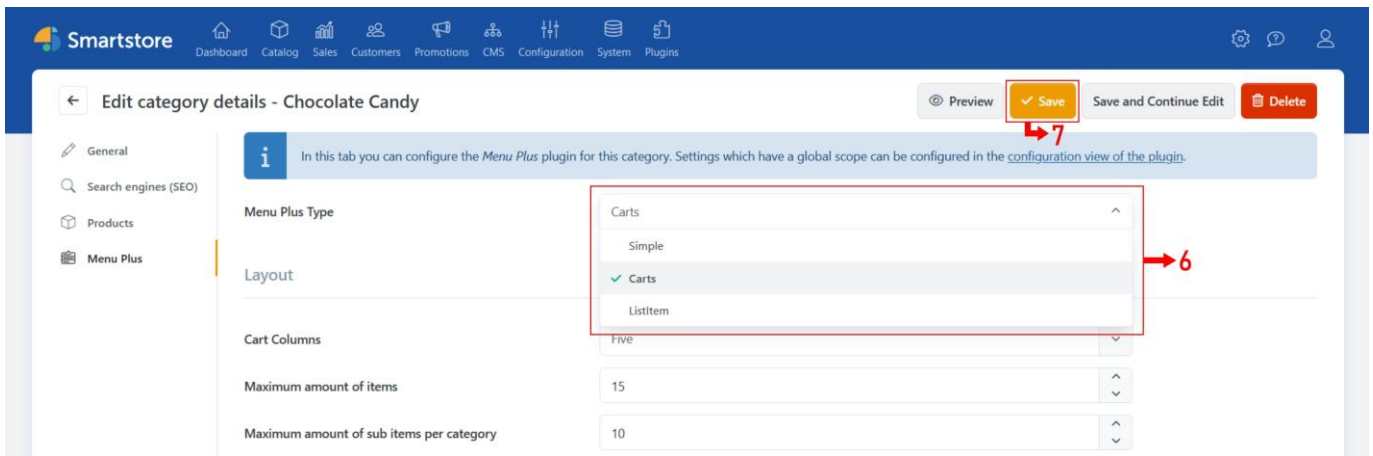
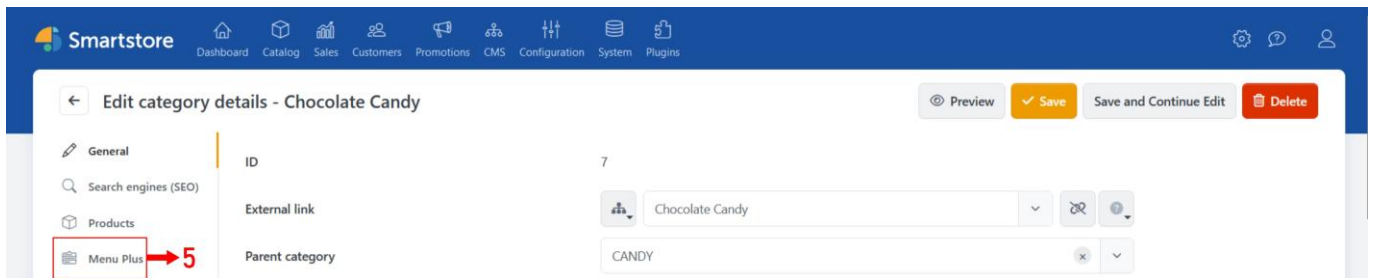
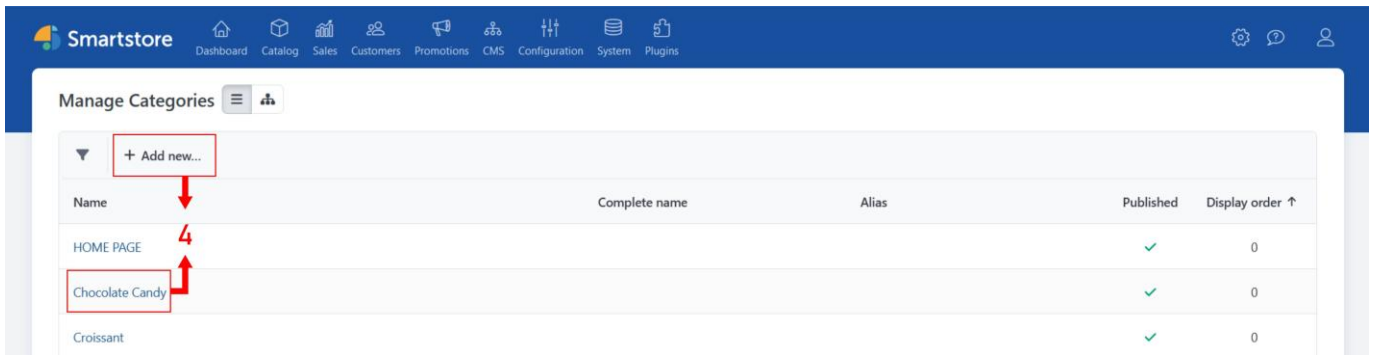

As you can see in the image in Step 4, Menu Plus has three options. The first option displays a simple dropdown menu, the second creates a card layout, and the third creates an itemized layout. You can also change the number of cards and items according to your preference and needs from the options below.

*** Brand or Manufacturers MenuPlus:**

If you have added a brand or Manufacturers to your template and want it to appear as a menuplus in the main menu, follow the steps below:

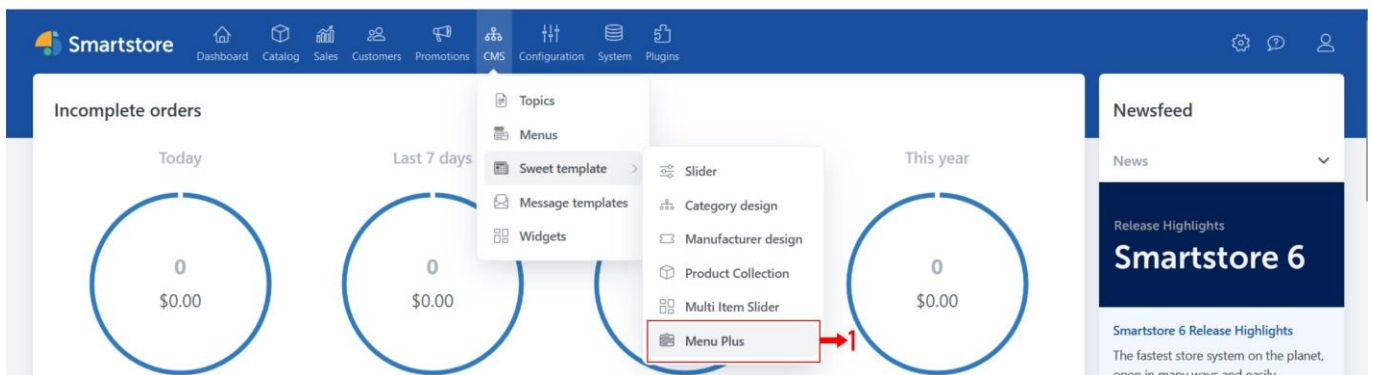

Smartstore Dashboard Catalog Sales Customers Promotions CMS Configuration System Plugins

Configure - Smartstore template Sweet Save Update resources

This Plugin will mainly be configured in category administration area. For this purpose there is a *Menu Plus* tab in configuration view of a category in which every menuplus dropdown element can be configured individually. Settings which have a global scope can be configured in the configuration view of the plugin.

Is active

Menu minimum height 0 Pixel

Brand Dropdownmenu

Display "Brand" menu → 2. Enable this option

Brand link placement Prepend to Menu

Sort order for textual links Alphabetical → 3. More setting

Brand Columns Six Columns

Amount of rows Two rows

4. Slider (1):

To create a simple slider, follow the steps below:

Smartstore Dashboard Catalog Sales Customers Promotions CMS Configuration System Plugins

Incomplete orders Today Last 7 days This year

0 \$0.00 0 \$0.00 0 \$0.00

Topics
Menus
Sweet template → Slider → 1
Message templates
Widgets
Category design
Manufacturer design
Product Collection
Multi Item Slider
Menu Plus

Newsfeed
News
Release Highlights
Smartstore 6
Smartstore 6 Release Highlights
The fastest store system on the planet, open in many ways and easily

Smartstore Dashboard Catalog Sales Customers Promotions CMS Configuration System Plugins

+ Add new... → 2

| Id | Skin Template | Name | Show zone | Display Order ↑ | Is active |
|-----|---------------|--------------|-------------------------------|-----------------|-----------|
| #1 | Default | main-slider | content_before | 0 | ✓ |
| #2 | Default | body-slider | home_page_after_categories | 0 | ✓ |
| #10 | ThreeSlide | three-slider | home_page_after_manufacturers | 0 | ✓ |

Displaying items 1-3 of 3 25 per page

Smartstore Dashboard Catalog Sales Customers Promotions CMS Configuration System Plugins

Slide

Cancel Save Save and Continue Edit

Is active

Name → 3

Display Order

Show zone

Skin Template

Limited to stores

Plugins.SmartPlugins.SimpleSlider.SaveBeforeAdd

Save and Continue Edit

- home_page_top
- home_page_after_intro
- home_page_after_categories
- home_page_after_products
- home_page_after_bestsellers
- home_page_after_manufacturers
- home_page_after_tags
- home_page_after_news

Select the area where you want the slider to be placed.

→ 4

Smartstore Dashboard Catalog Sales Customers Promotions CMS Configuration System Plugins

Slide

Cancel Save Save and Continue Edit

Is active

Name

Display Order

Show zone

Skin Template

Limited to stores

Plugins.SmartPlugins.SimpleSlider.SaveBeforeAdd

Save and Continue Edit

- Default
- Three Slide

→ 5

→ 6

Smartstore Dashboard Catalog Sales Customers Promotions CMS Configuration System Plugins

Slide

Cancel Save Save and Continue Edit Delete

Is active

Name

Display Order

Show zone

Skin Template

Limited to stores

+ Add new... → 7

| Id | Display Order ↑ | Is active |
|---------|-----------------|-----------|
| No data | | |

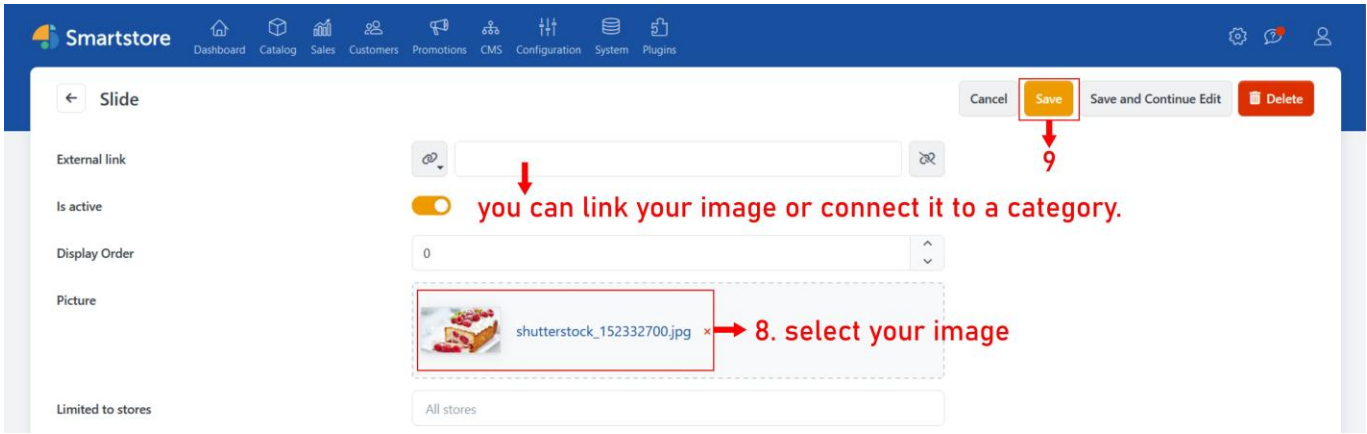

The size of the images used in the slider of this template is 1920 * 1100 pixels.

5. Multi Item Slider (1):

To create a multi-item slider, follow the steps below:

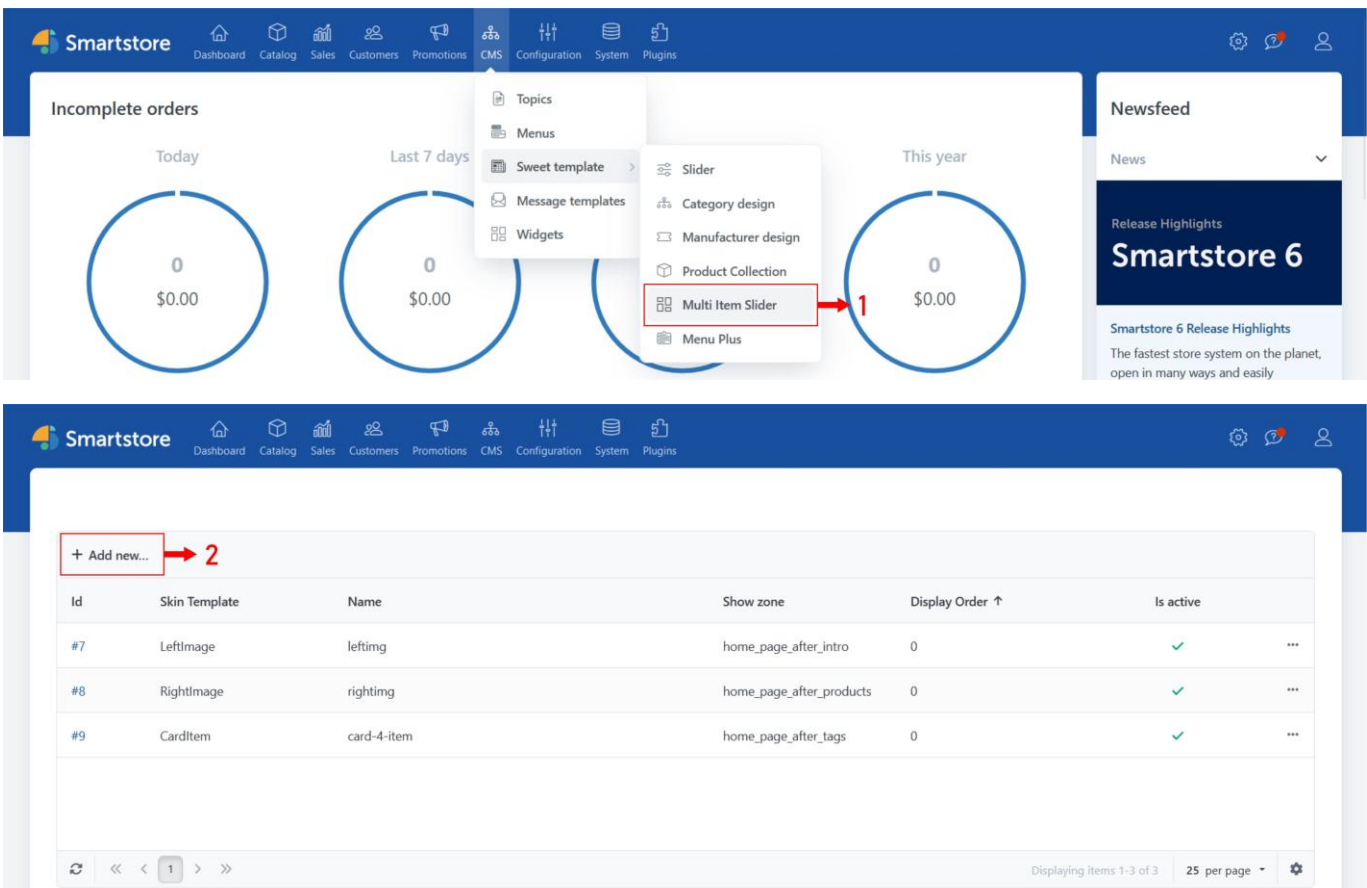

Smartstore Dashboard Catalog Sales Customers Promotions CMS Configuration System Plugins

Slide details

Cancel Save **Save and Continue Edit** → 6

Is active

Name → 3

Display Order

Show zone → 4. Select the area where you want the multi-item slider to be placed.

Skin Template

Limited to stores

Plugins.SmartPlugins.MultitemSlider.SaveBeforeAdd

→ 5

Smartstore Dashboard Catalog Sales Customers Promotions CMS Configuration System Plugins

Slide details

Cancel Save Save and Continue Edit **Delete**

Is active

Name

Display Order

Show zone

Skin Template

Limited to stores

→ 7

| Id | Display Order ↑ | Is active | |
|-----|-----------------|-------------------------------------|-----|
| #13 | 0 | <input checked="" type="checkbox"/> | ... |

Smartstore Dashboard Catalog Sales Customers Promotions CMS Configuration System Plugins

Slide details

Cancel Save Save and Continue Edit Delete

Is active

Display Order 0

Externer Link Croissant

Picture  9e2a6efdcf.jpg

Tagline

Title Welcome to our sweet shop!

Intro

Text Start your morning with a delicious croissant and fuel your day with energy and positivity. Whether you're gearing up for work, school, or a busy schedule, there's no better way to begin than with the perfect blend of flavor and satisfaction. Let the taste inspire your day!

Display button

Button Text See More!

Limited to stores All stores

11

you can link your image or connect it to a category.

8. select your image

9. Write your title, tagline, intro or text.

10. If you want a button for your item, you can use this section. Otherwise, turn off the button so that it will not be displayed.

The size of the images used in the multi item slider of this template is 850 * 550 pixels.

6. Category Design:

When you add a category, you can display it on the homepage by activating a button.

Smartstore Dashboard Catalog Sales Customers Promotions CMS Configuration System Plugins

Incomplete orders

Today Last 28 days This year

0 \$0.00 0 \$0.00 0 \$0.00

Orders \$0.00

Categories

Manage products

Product reviews

Manufacturers

Product tags

Low stock report

Recycle bin

ATTRIBUTES

Product Attributes

Specification Attributes

Checkout Attributes

1

Newsfeed

News

Release Highlights

Smartstore 6

Smartstore 6 Release Highlights

The fastest store system on the planet, open in many ways and easily expandable for any business model: this is the brand new Smartstore 6, the indispensable technological basis for anyone who wants to be at the top of their industry, categories and incredible

Today Yesterday Last 7 days Last 28 days This year

Smartstore Dashboard Catalog Sales Customers Promotions CMS Configuration System Plugins

Manage Categories

+ Add new...

| Name | Complete name | Alias | Published | Display order ↑ |
|-------------------|---------------|-------|-----------|-----------------|
| Wedding | | | ✓ | 0 |
| Cupcake | | | ✓ | 0 |
| Macaron | | | ✓ | 0 |
| CANDY | | | ✓ | 1 |
| DESSERT | | | ✓ | 2 |
| CAKE | | | ✓ | 3 |
| TRADITIONAL SWEET | | | ✓ | 4 |
| BRFAD | | | ✓ | 5 |

Displaying items 1-21 of 21 25 per page

→ 2. You can choose any category you want to be on the main page

Smartstore Dashboard Catalog Sales Customers Promotions CMS Configuration System Plugins

Edit category details - CANDY

Preview Save Save and Continue Edit Delete

4

3

General

ID 2

External link CANDY

Parent category [Unspecified]

Display order 1

Published

Show on home page

Name CANDY

Complete name

Top description Click to edit HTML...

Show other description

Badge text

Badge style Secondary Example

Picture candy.png

However, in addition to this method, you can also use the related module to show the category on the homepage. These two methods differ in design. To add a category using this module, follow the steps below:

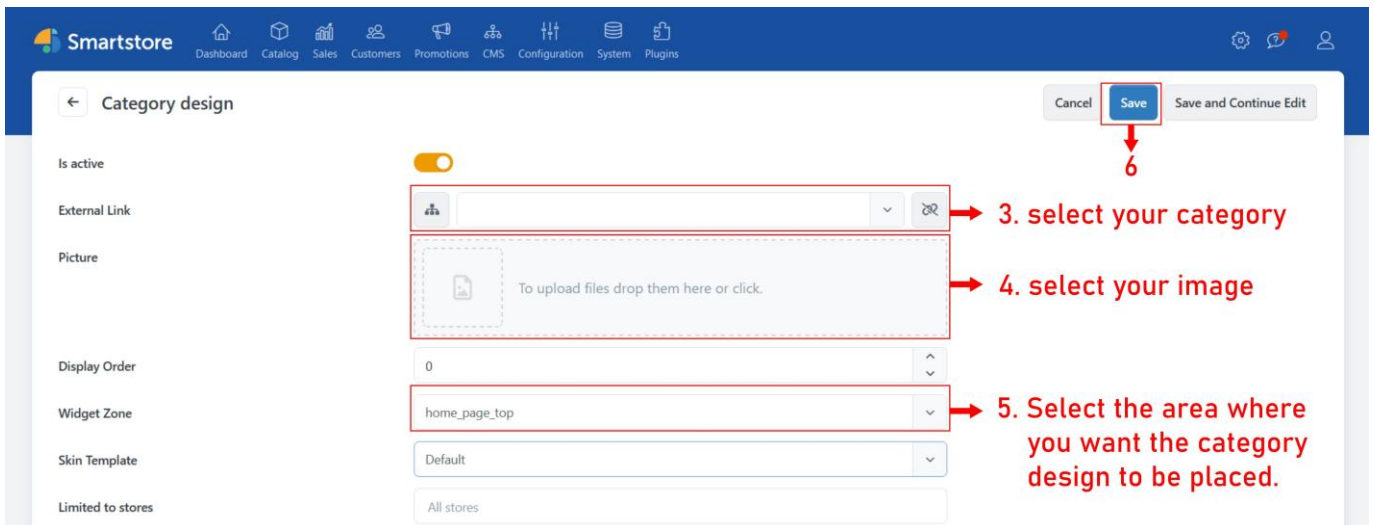
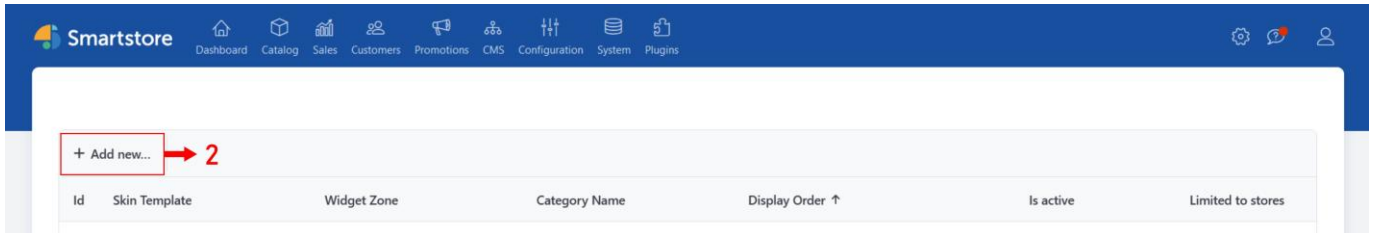
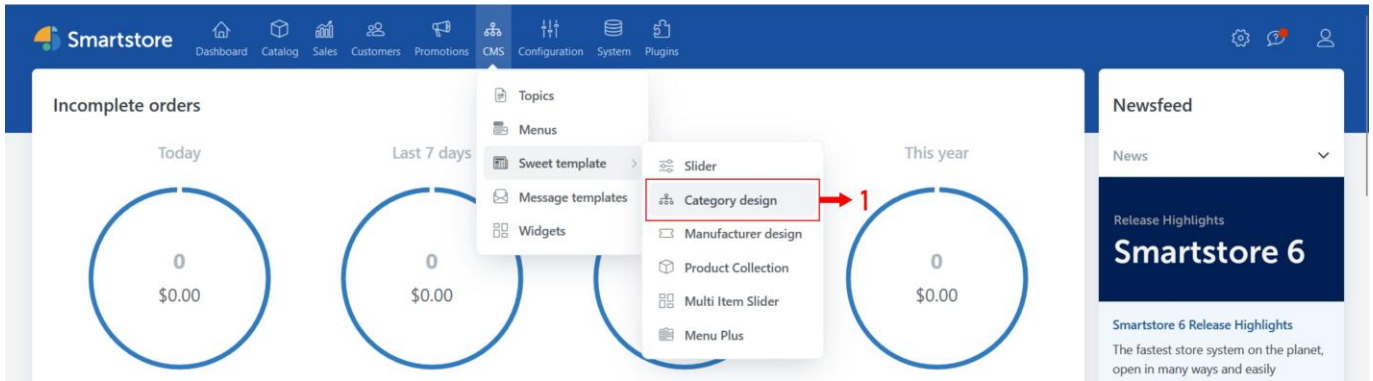

7. Slider (2):

This step is the same as Step 4.

The size of the images used in the slider of this template is 1920 * 600 pixels.

8. Product:

To add a product, use the link below:

<https://smartstore.atlassian.net/wiki/spaces/SMNET50/pages/1956119693/Managing+Products>

9. Multi Item Slider (2):

To create a multi-item slider, follow the steps below:

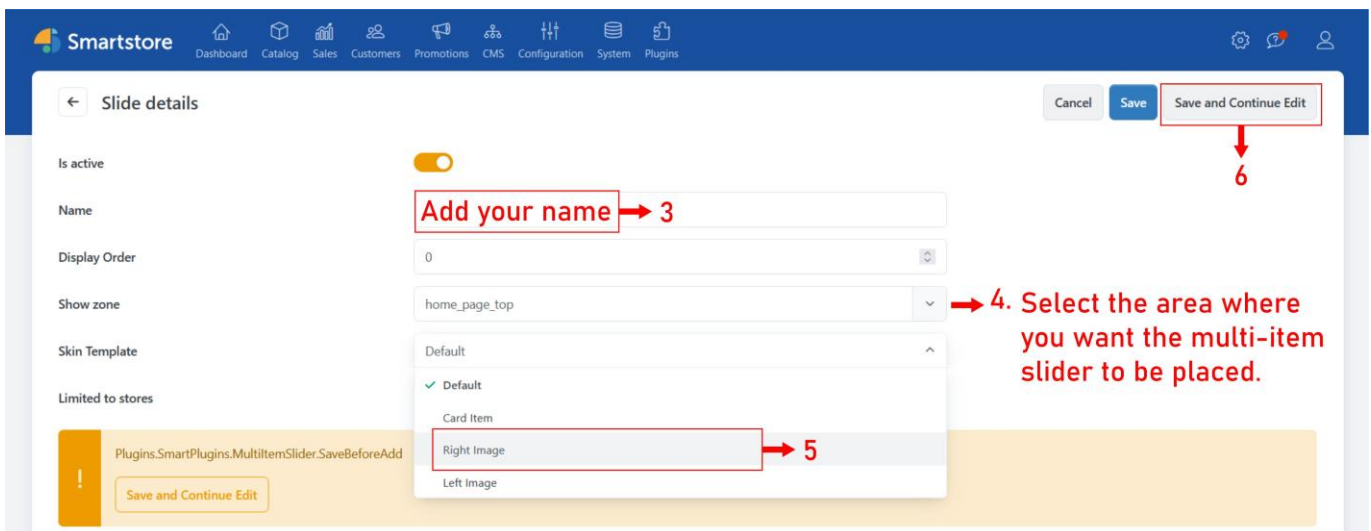
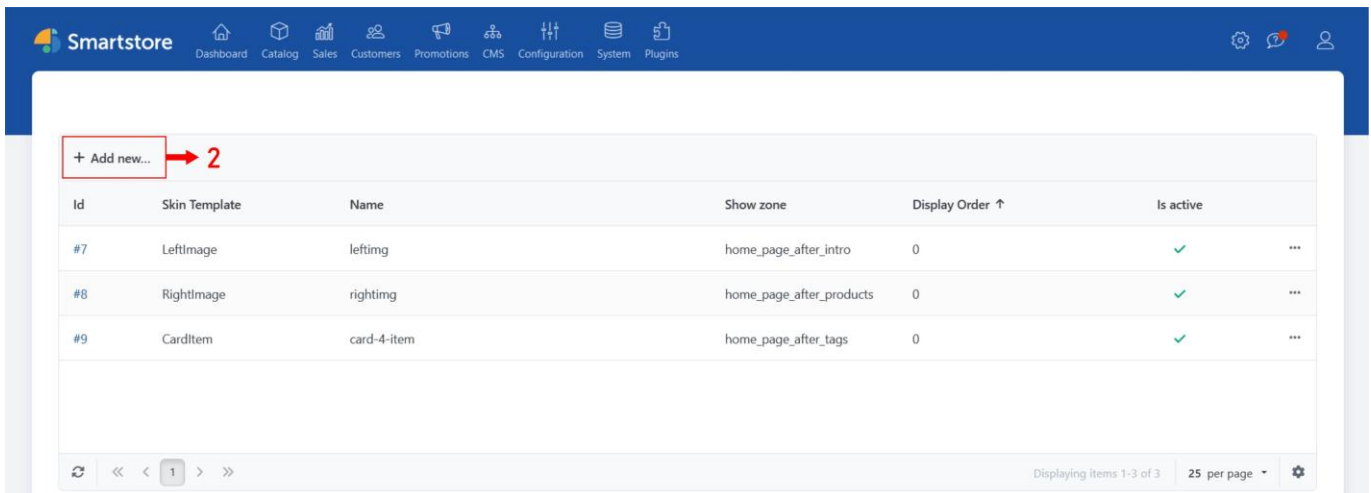
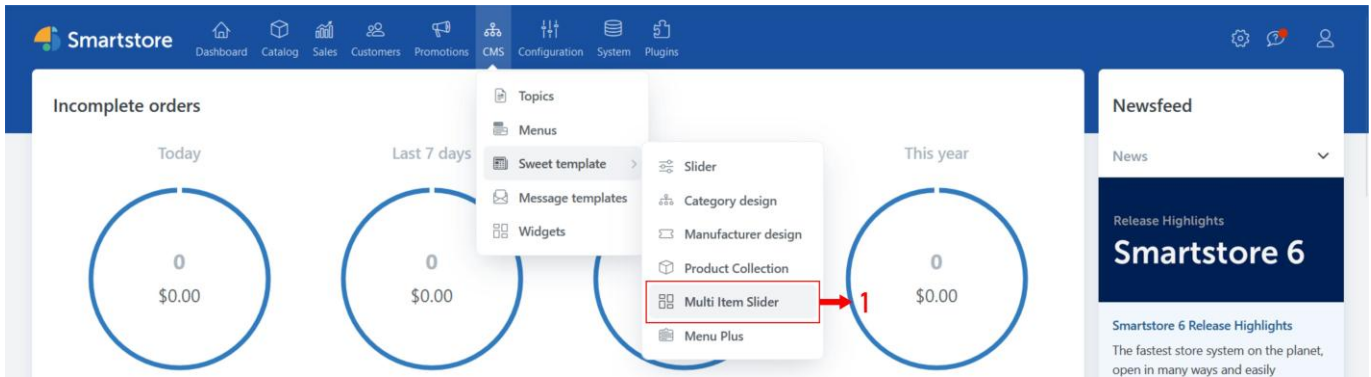

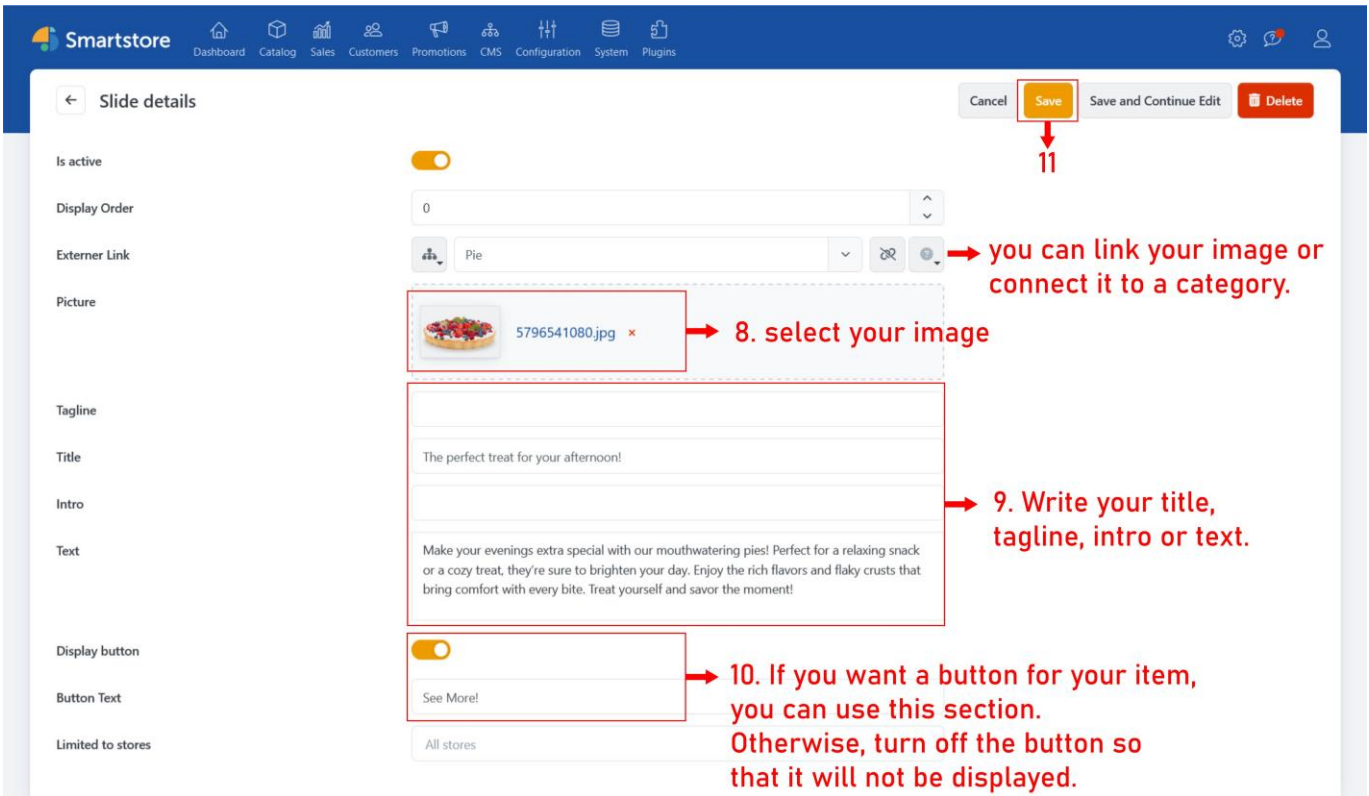
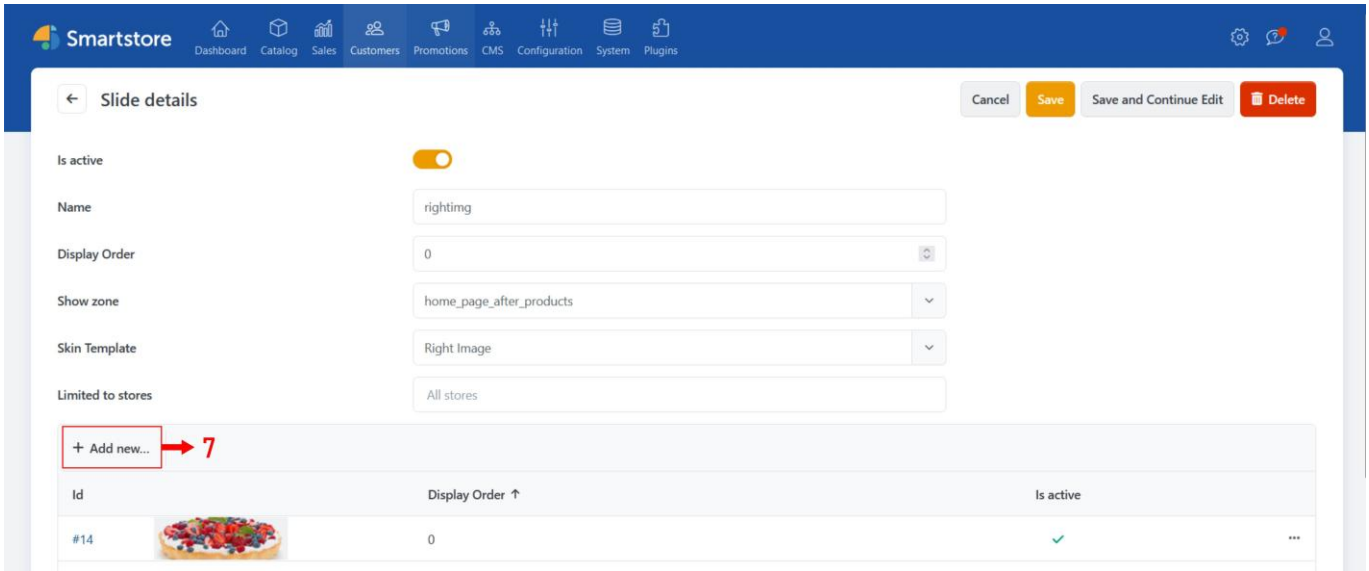

The size of the images used in the multi item slider of this template is 850 * 550 pixels.

10. Slider (3):

To create a Three slider, follow the steps below:

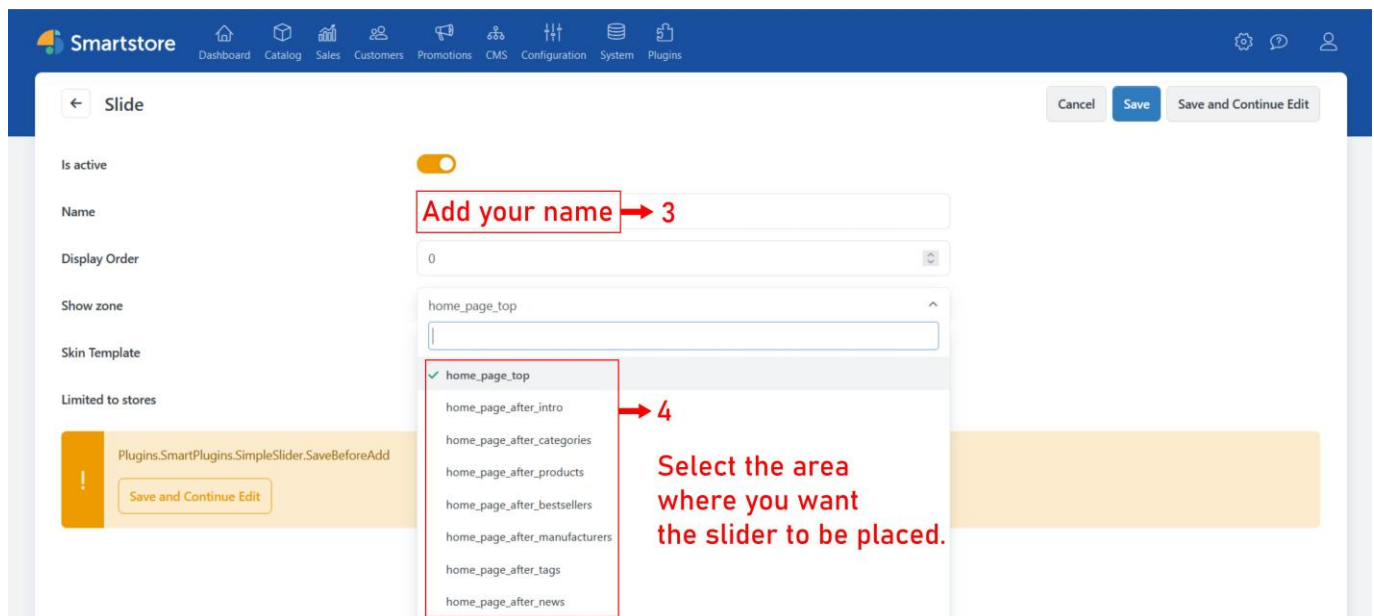
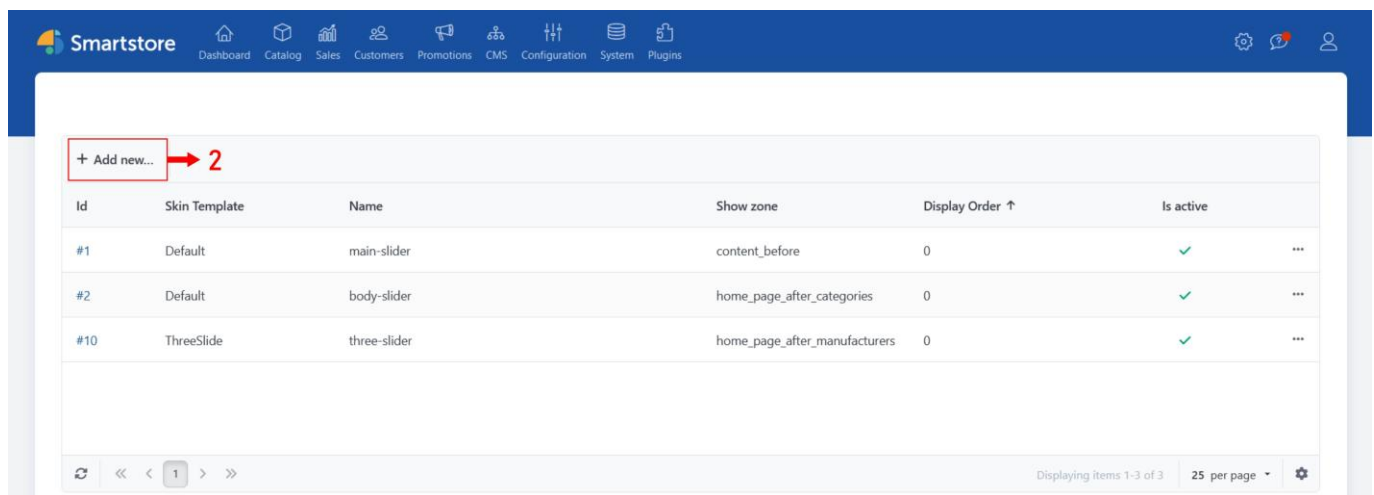
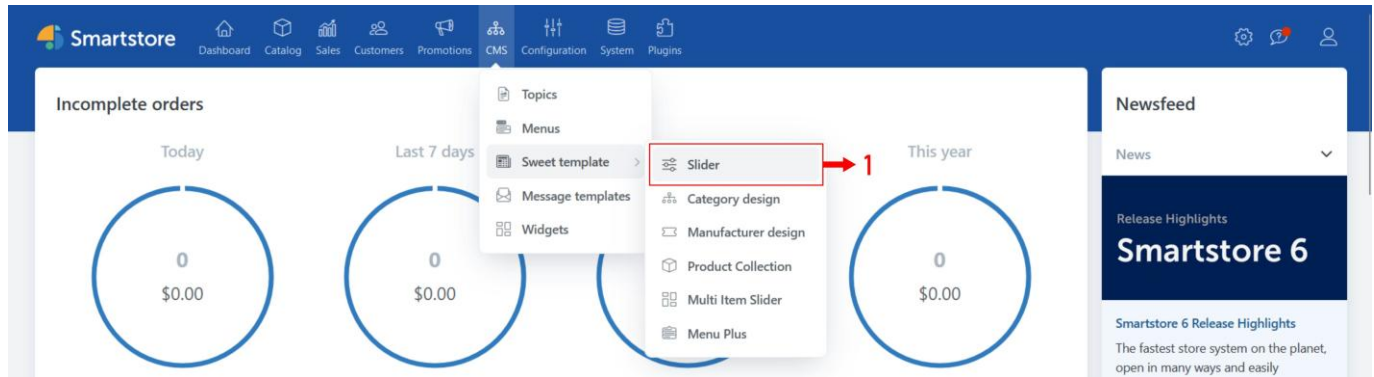

Smartstore Dashboard Catalog Sales Customers Promotions CMS Configuration System Plugins

Slide

Cancel Save Save and Continue Edit Delete

Is active

Name three-slider







Display Order 0

Show zone home_page_after_manufacturers

Skin Template Three Slide

Limited to stores All stores

+ Add new... → 7

| Id | Image | Display Order ↑ | Is active | |
|-----|---|-----------------|-------------------------------------|-----|
| #27 |  | 0 | <input checked="" type="checkbox"/> | ... |
| #28 |  | 0 | <input checked="" type="checkbox"/> | ... |
| #29 |  | 0 | <input checked="" type="checkbox"/> | ... |
| #30 |  | 0 | <input checked="" type="checkbox"/> | ... |
| #31 |  | 0 | <input checked="" type="checkbox"/> | ... |
| #32 |  | 0 | <input checked="" type="checkbox"/> | ... |

Displaying items 1-6 of 6 25 per page

Smartstore Dashboard Catalog Sales Customers Promotions CMS Configuration System Plugins

Slide

Cancel Save Save and Continue Edit Delete

External link

Is active you can link your image or connect it to a category.

Display Order 0

Picture  Chocolate candy.jpg × → 8. select your image

Limited to stores All stores

The size of the images used in the slider of this template is 450 * 350 pixels.

11. Multi Item Slider (3):

To create a multi-item slider, follow the steps below:

The first screenshot shows the Smartstore dashboard with the CMS menu open. The 'Multi Item Slider' option is highlighted with a red box and labeled '1'.

The second screenshot shows the 'Slide details' page with a table of existing slides. The '+ Add new...' button is highlighted with a red box and labeled '2'.

| Id | Skin Template | Name | Show zone | Display Order ↑ | Is active |
|----|---------------|-------------|--------------------------|-----------------|-----------|
| #7 | LeftImage | leftimg | home_page_after_intro | 0 | ✓ |
| #8 | RightImage | rightimg | home_page_after_products | 0 | ✓ |
| #9 | CardItem | card-4-item | home_page_after_tags | 0 | ✓ |

The third screenshot shows the 'Slide details' form. The 'Name' field is highlighted with a red box and labeled '3'. The 'Show zone' dropdown is highlighted with a red box and labeled '4'. The 'Card Item' option in the 'Skin Template' dropdown is highlighted with a red box and labeled '5'. The 'Save and Continue Edit' button is highlighted with a red box and labeled '6'.

4. Select the area where you want the multi-item slider to be placed.

Smartstore Dashboard Catalog Sales Customers Promotions CMS Configuration System Plugins

Slide details

Cancel Save Save and Continue Edit Delete

Is active

Name card-4-item

Display Order 0

Show zone home_page_after_tags

Skin Template Card Item

Limited to stores All stores

+ Add new... → 7

| Id | Display Order ↑ | Is active |
|-----|-----------------|-----------|
| #15 | 0 | ✓ |
| #16 | 0 | ✓ |
| #25 | 0 | ✓ |
| #26 | 0 | ✓ |

Displaying items 1-4 of 4 25 per page

Smartstore Dashboard Catalog Sales Customers Promotions CMS Configuration System Plugins

Slide details

Cancel Save Save and Continue Edit Delete

Is active

Display Order 0

Externer Link #

Picture → 8. select your image

Tagline

Title Appropriate Packaging

Intro We ensure that our products are packaged with the utmost care and delivered to you in perfe → 9. Write your title, tagline, intro or text.

Text [Click to edit HTML...](#)

Display button → 10. If you want a button for your item, you can use this section. Otherwise, turn off the button so that it will not be displayed.

Limited to stores All stores

11

The size of the images used in the multi item slider of this template is 800 * 600 pixels.

12. Recently Viewed Product:

This section will be displayed when you view the products in your store.

13. Social Media:

In this section, you can place the links to the social media pages.

