







Digital Template Help:

The file you see is the configuration and usage guide for the Digital template module. This document aims to explain the steps in a simple and clear manner, with pictures.





Please follow along with us:

After installing the template module Digital, go to the "Modules" folder and then enter "SmartPlugins.Themes.Digital" folder.

Then run the "create-deployed-symlinks" file.

Name	Date modified	Type	Size
App_Data	1/4/2025 11:47 AM	File folder	
Localization	1/4/2025 11:47 AM	File folder	
Views	1/4/2025 11:47 AM	File folder	
wwwroot	1/4/2025 11:47 AM	File folder	
 create-deployed-symlinks	10/17/2024 2:24 PM	Windows Batch File	1 KB
 module	10/17/2024 2:24 PM	JSON File	1 KB
 SmartPlugins.Themes.Digital.deps	1/4/2025 11:47 AM	JSON File	329 KB
 SmartPlugins.Themes.Digital.dll	1/4/2025 11:47 AM	Application extens...	1,187 KB
 SmartPlugins.Themes.Digital.pdb	1/4/2025 11:47 AM	Program Debug D...	436 KB
 SmartPlugins.Themes.Digital.staticwebas...	1/4/2025 11:47 AM	JSON File	1,899 KB
 theme.config	1/1/2025 9:06 PM	XML Configuration...	11 KB

After running this file, the Digital folder will be automatically created in the theme folder.

Name	Date modified	Type	Size
 Digital	10/17/2024 2:28 PM	File folder	
 Flex	7/6/2024 8:07 PM	File folder	
 FlexBlack	7/6/2024 8:06 PM	File folder	
 FlexBlue	7/6/2024 8:06 PM	File folder	

Then go to the admin panel and proceed as shown in the image:

Smartstore Dashboard

Navigation: Dashboard, Catalog, Sales, Customers, Promotions, CMS, Configuration, System, Plugins

Configuration Menu: Settings, Stores, Regional Settings, Payment methods, Lists, Email Accounts, Activity Types, Import, Export, **Themes**

Summary Cards: Incomplete orders (Today: \$0.00, Last 7 days: \$0.00, This year: \$0.00)

Newsfeed: Smartstore 6 Release Highlights

Orders: \$0.00

Time filters: Today, Yesterday, Last 7 days, Last 28 days, This year

Smartstore Themes

Buttons: Save, Reload themes, Upload theme

Store: market

Installed themes:

- Flex (Active)
- Flex Blue (Activate)
- Flex Black (Activate)

Smartstore Themes

Buttons: Save, Reload themes, Upload theme

Store: Your store name

Installed themes:

- Flex (Active)
- Flex Black (Activate)
- Flex Blue (Activate)
- Digital (Activate)**

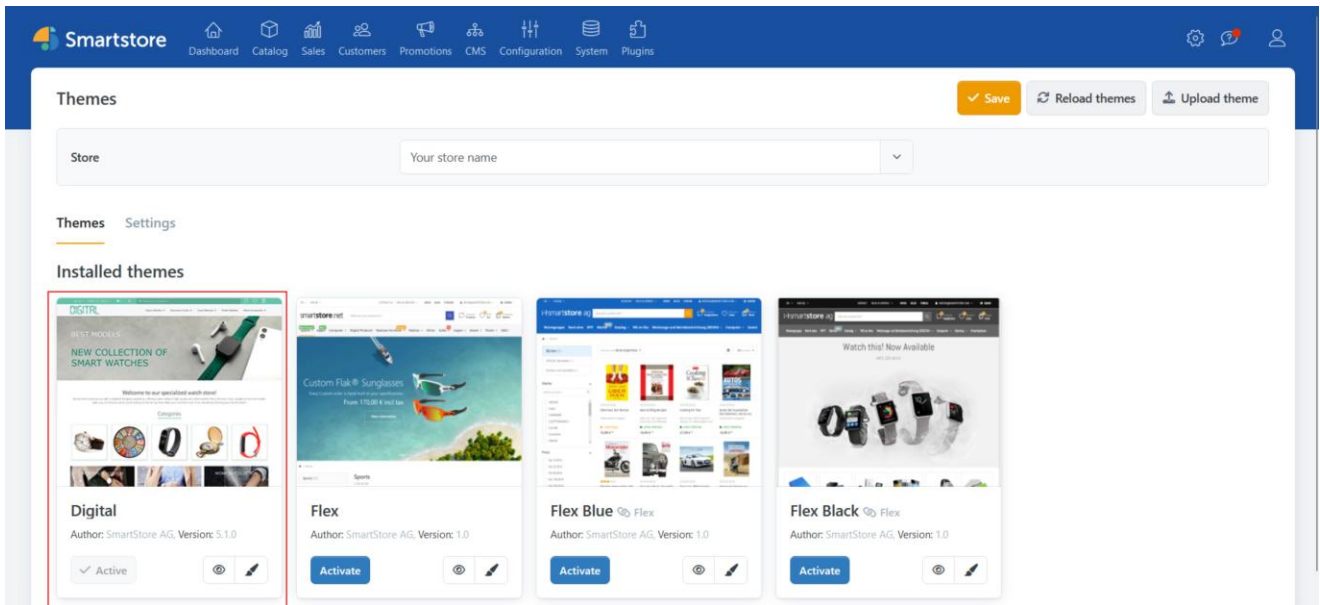

Now, follow the images below for active widgets and using the modules:

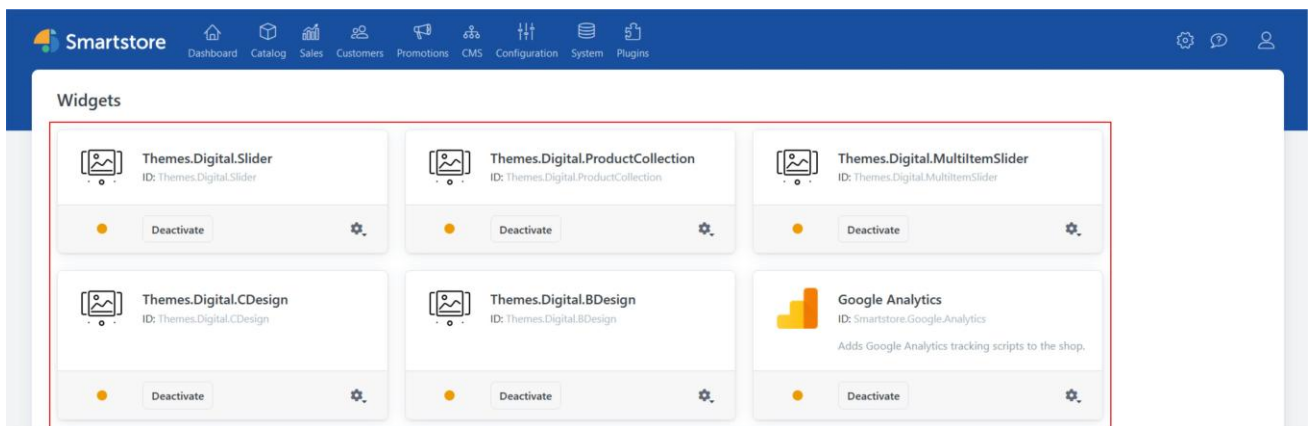
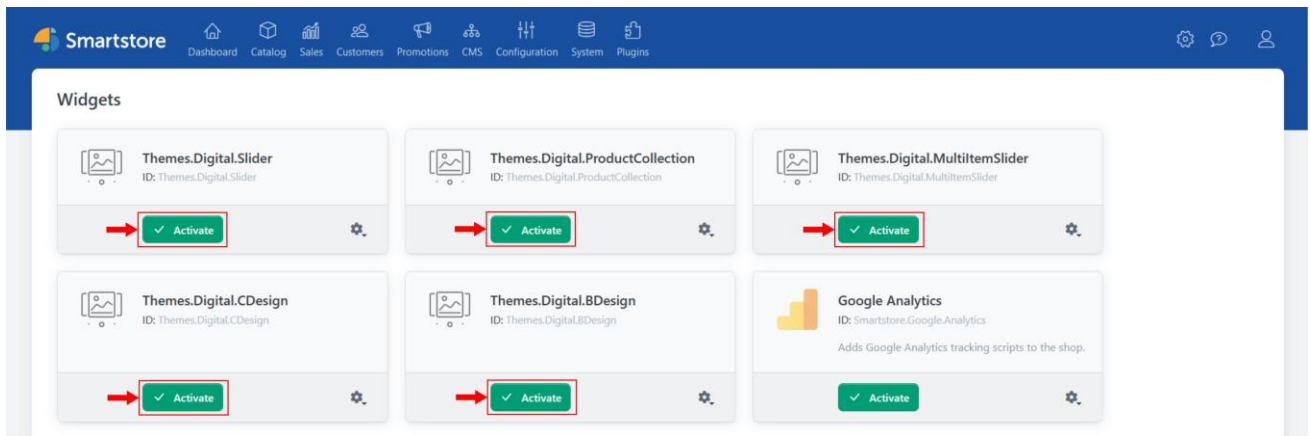
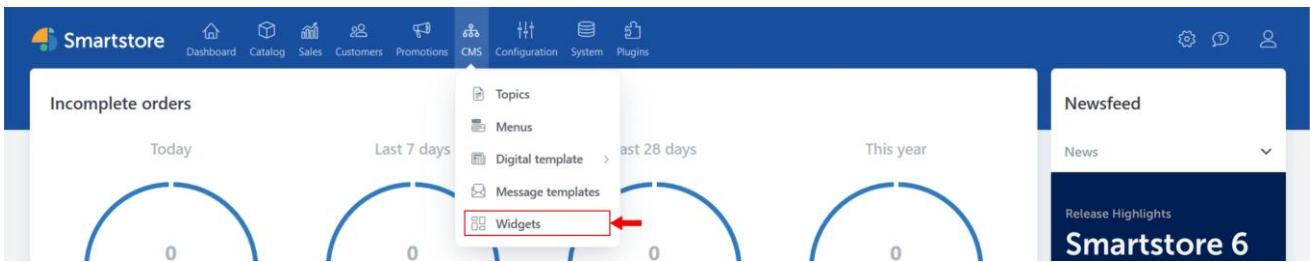

Now that the template is installed and all the modules are ready, you need to add your information to the template. In the image below, all the sections of the template we have prepared are highlighted separately.

For an explanation of each section, refer to the corresponding section:

1. Logo

2. Menu

3. Menu Plus

4. Slider (1)

5. Topics

6. Category Design

7. Multi Item Slider (1)

8. Product

9. Multi Item Slider (2)

10. Product Collection (1)

11. Product Collection (2)

12. Multi Item Slider (3)

13. Manufacture Design

14. Slider (2)

15. Recently Viewed Product

16. Social Media

1. logo:

In this section, you can upload your desired logo. The logo dimensions can be approximately as follows: a width of around 300 pixels and a height of around 80 pixels.

Follow these steps the Admin Panel to add your personal logo:

The first screenshot shows the Smartstore Admin Panel dashboard. A red box highlights the 'Stores' option in the 'Settings' menu, with a red arrow pointing to it and the number '1'. The dashboard includes sections for 'Incomplete orders' with three circular gauges showing \$0.00 for 'Today', 'Last 7 days', and 'This year'. A 'Newsfeed' section on the right features 'Smartstore 6 Release Highlights'.

The second screenshot shows the 'Stores' management page. A table lists store details. A red box highlights the 'digital' store name, with a red arrow pointing to it and the number '2'. The table has columns for 'Store name', 'Shop URL', 'HOST values', 'Content Delivery Net...', 'Require HTTPS', and 'Display order'. The 'digital' store has a Shop URL of 'https://digital.smart-plugins.com/' and 'Require HTTPS' checked.

The third screenshot shows the 'Edit store details' page for the 'digital' store. A red box highlights the 'Store logo' upload area, which contains a preview of the 'DIGITAL' logo and the text 'logo.png'. A red arrow points to this area with the text '3. Drag your logo here'. At the top right, a red box highlights the 'Save' button, with a red arrow pointing to it and the number '4'. Other buttons include 'Save and Continue Edit' and 'Delete'.

2. Menu:

To add a category and its subcategories, use the link below:

<https://smartstore.atlassian.net/wiki/spaces/SMNET50/pages/1956119658/Organizing+Product+Categories>

3. Menu Plus:

"Menu Plus" can be activated whether you have already created a category or intend to create a new one. To activate **Menu Plus**, follow these steps:

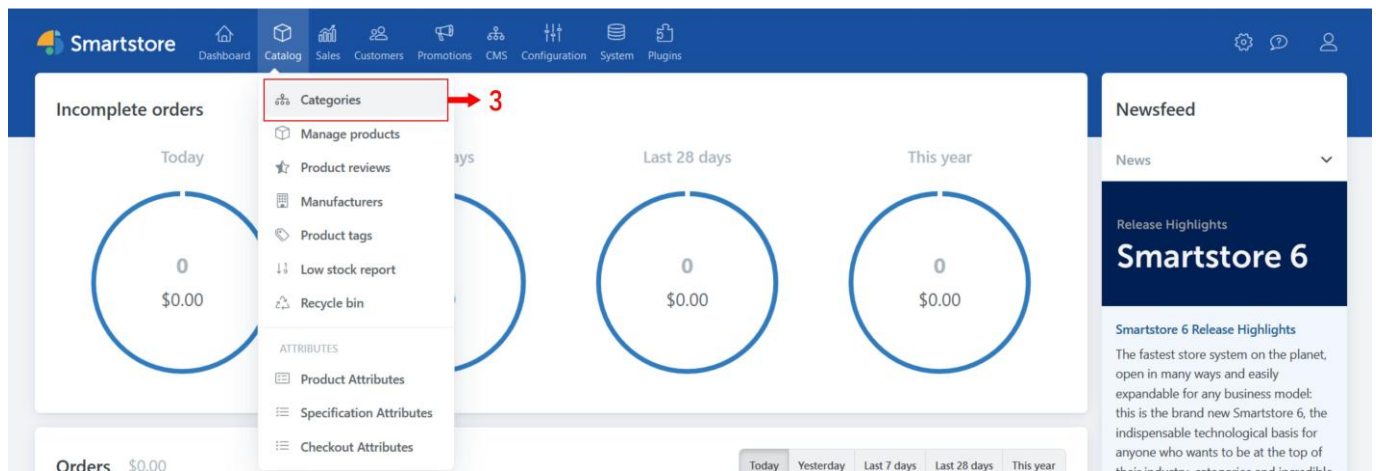
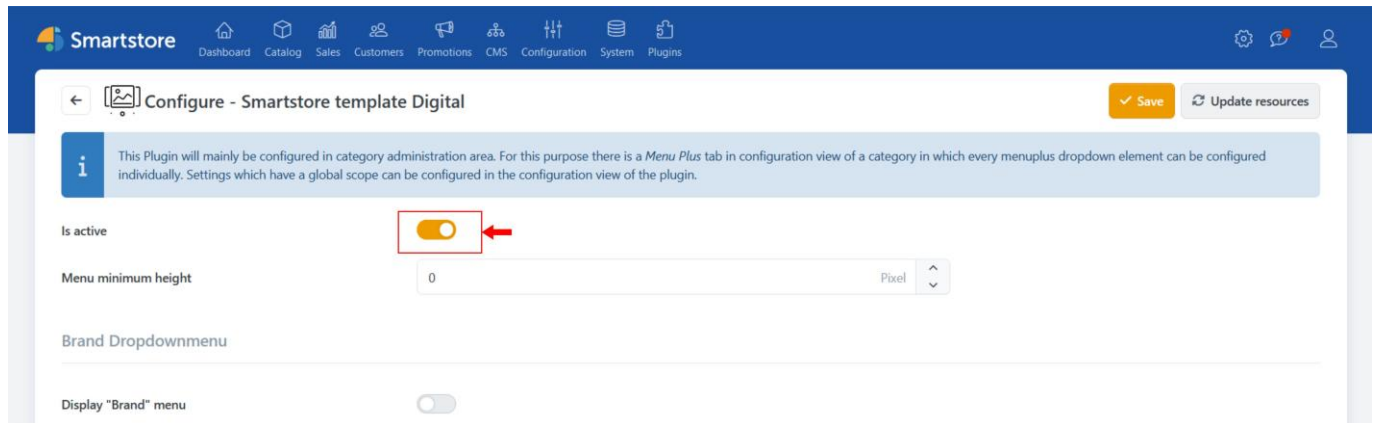
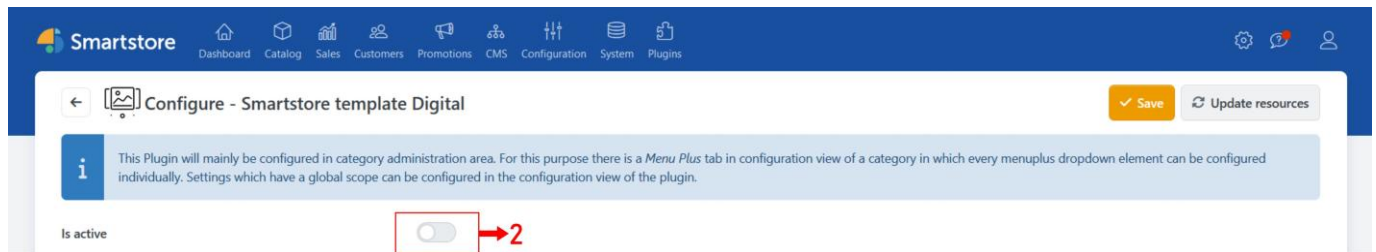
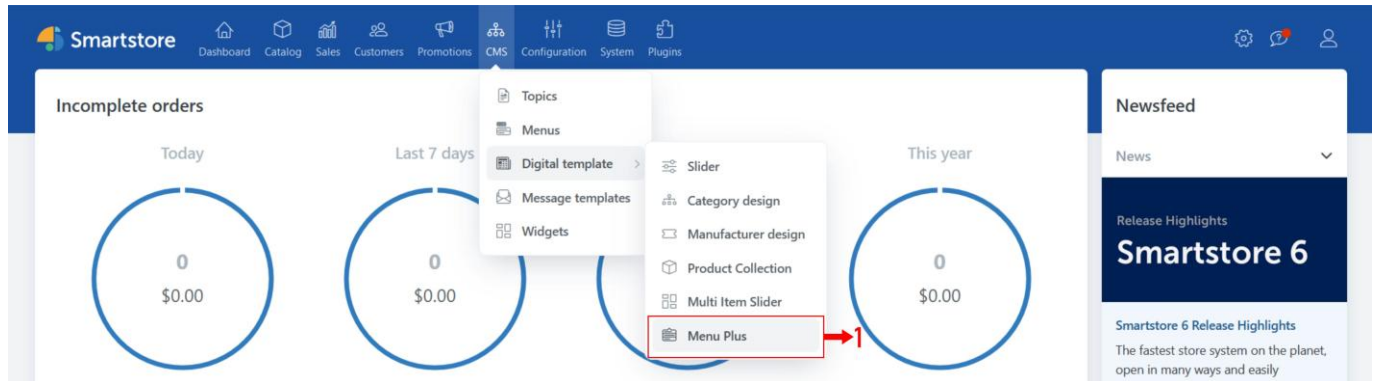

Smartstore Dashboard Catalog Sales Customers Promotions CMS Configuration System Plugins

Manage Categories

+ Add new...

Name	Complete name	Alias	Published	Display order ↑
Classic Watches → 4	Classic Watches		✓	0
Analog Watches	Analog Watches		✓	0
Digital Watches	Digital Watches		✓	0
Dual Time Display	Dual Time Display		✓	0
Basic Smart Watches	Basic Smart Watches		✓	0
Health & Sport Watches	Health & Sport Watches		✓	0
Kids Smartwatch	Kids Smartwatch		✓	0
Kids Wathes	Kids Wathes		✓	0

Displaying items 1-18 of 18 25 per page

Smartstore Dashboard Catalog Sales Customers Promotions CMS Configuration System Plugins

Edit category details - Classic Watches

Preview Save Save and Continue Edit Delete

- General
- Search engines (SEO)
- Products
- MenuPlus → 5**

ID: 6

External link: Classic Watches

Parent category: [Unspecified]

Display order: 0

Published:

Show on home page:

Name: Classic Watches

Smartstore Dashboard Catalog Sales Customers Promotions CMS Configuration System Plugins

Edit category details - Classic Watches

Preview Save → 7 Save and Continue Edit Delete

i In this tab you can configure the *Menu Plus* plugin for this category. Settings which have a global scope can be configured in the [configuration view of the plugin](#).

Menu Plus Type: Cart → 6

Layout: Cart

Cart Columns: Five

Maximum amount of items: 15

Maximum amount of sub items per category: 10

As you can see in the image in Step 4, Menu Plus has three options. The first option displays a simple dropdown menu, the second creates a card layout, and the third creates an itemized layout. You can also change the number of cards and items according to your preference and needs from the options below.

* Brand or Manufacturers MenuPlus:

If you have added a brand or Manufacturers to your template and want it to appear as a menuplus in the main menu, follow the steps below:

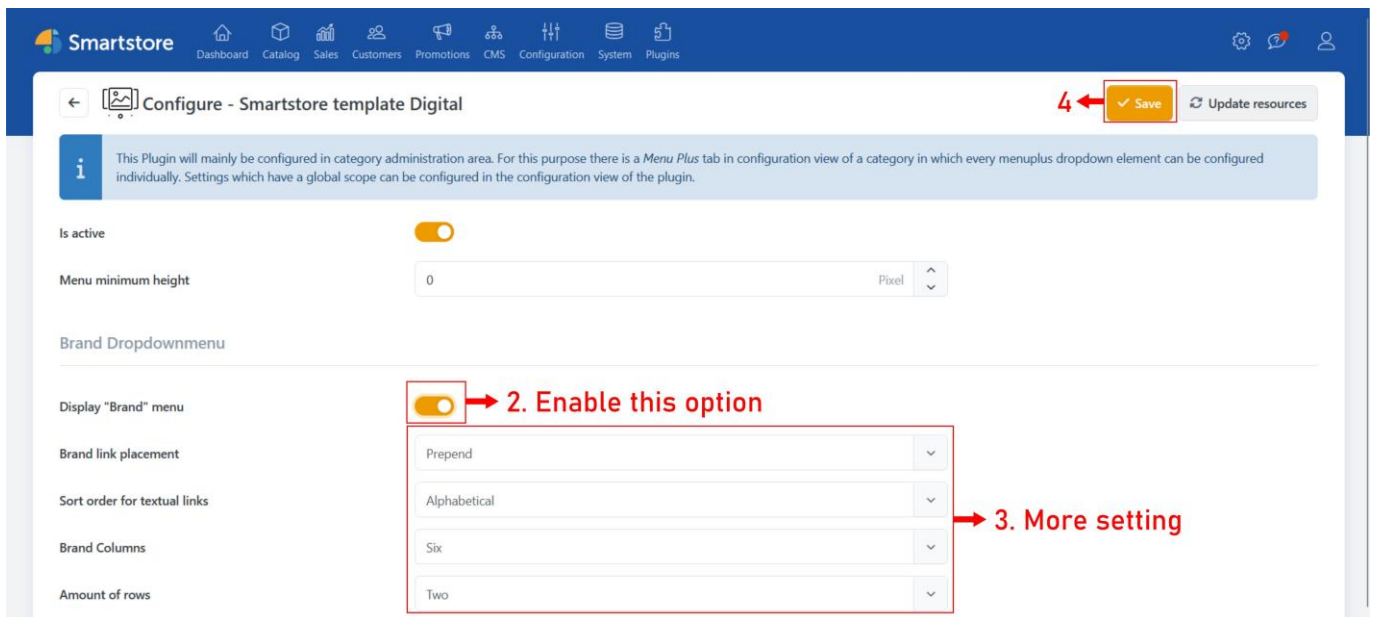
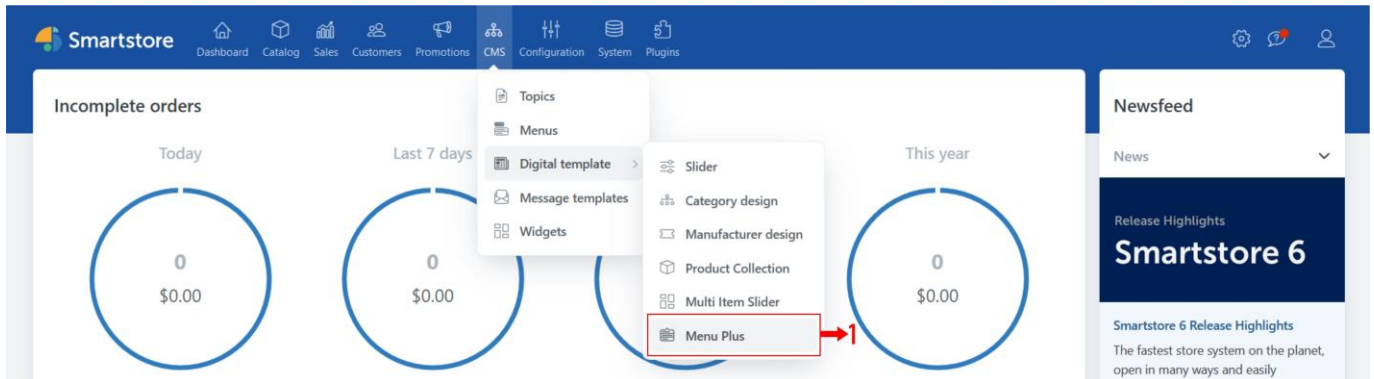

4. Slider (1):

To create a simple slider, follow the steps below:

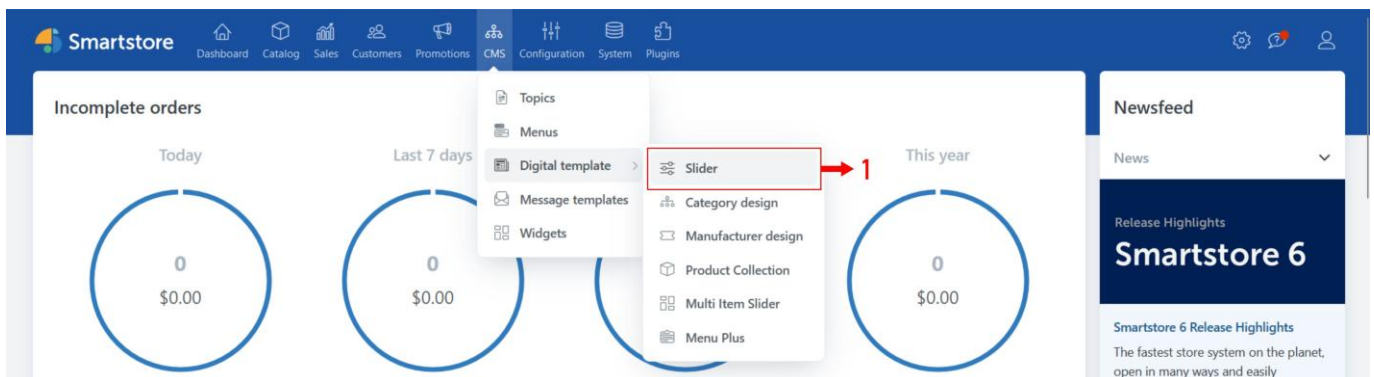

Smartstore Dashboard Catalog Sales Customers Promotions CMS Configuration System Plugins

+ Add new... → 2

Id	Skin Template	Name	Show zone	Display Order ↑	Is active
#1	Default	main slider	content_before	0	✓
#22	Default	fullbottomback	home_page_after_tags	0	✓

Displaying items 1-2 of 2 25 per page

Smartstore Dashboard Catalog Sales Customers Promotions CMS Configuration System Plugins

Slide

Cancel Save Save and Continue Edit

Is active

Name

Display Order

Show zone

Skin Template

Limited to stores

Plugins.SmartPlugins.SimpleSlider.SaveBeforeAdd

Save and Continue Edit

home_page_top ✓ → 4

home_page_after_intro

home_page_after_categories

home_page_after_products

home_page_after_bestellers

home_page_after_manufacturers

Select the area where you want the slider to be placed.

5

Smartstore Dashboard Catalog Sales Customers Promotions CMS Configuration System Plugins

Slide

Cancel Save Save and Continue Edit Delete

Is active

Name

Display Order

Show zone

Skin Template

Limited to stores

+ Add new... → 6

Id	Image	Display Order ↑	Is active
#1		0	✓

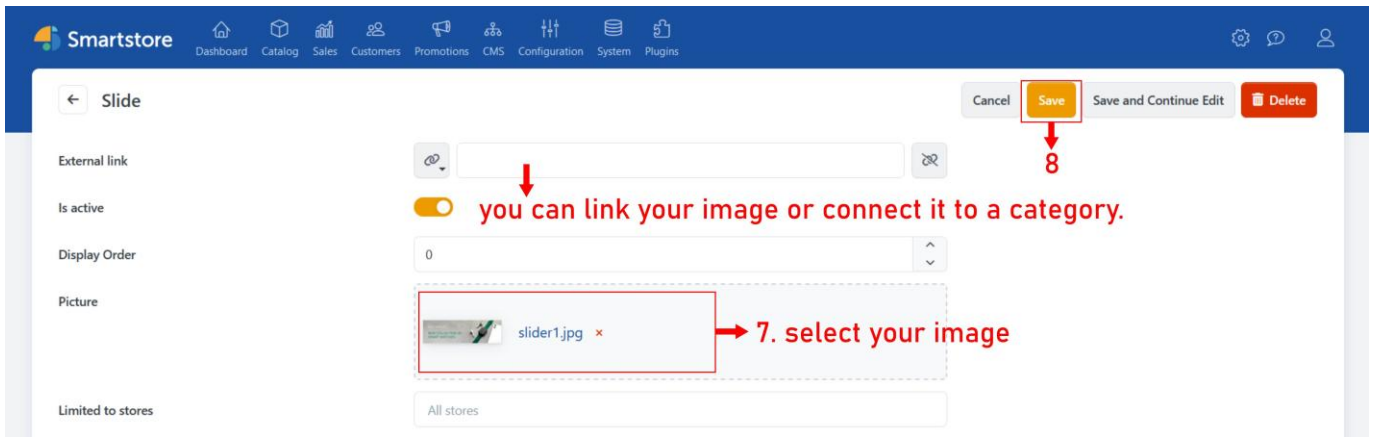

The size of the images used in the slider of this template is 1920 * 550 pixels.

5. Topics:

To add this section using Topics, follow the steps below:

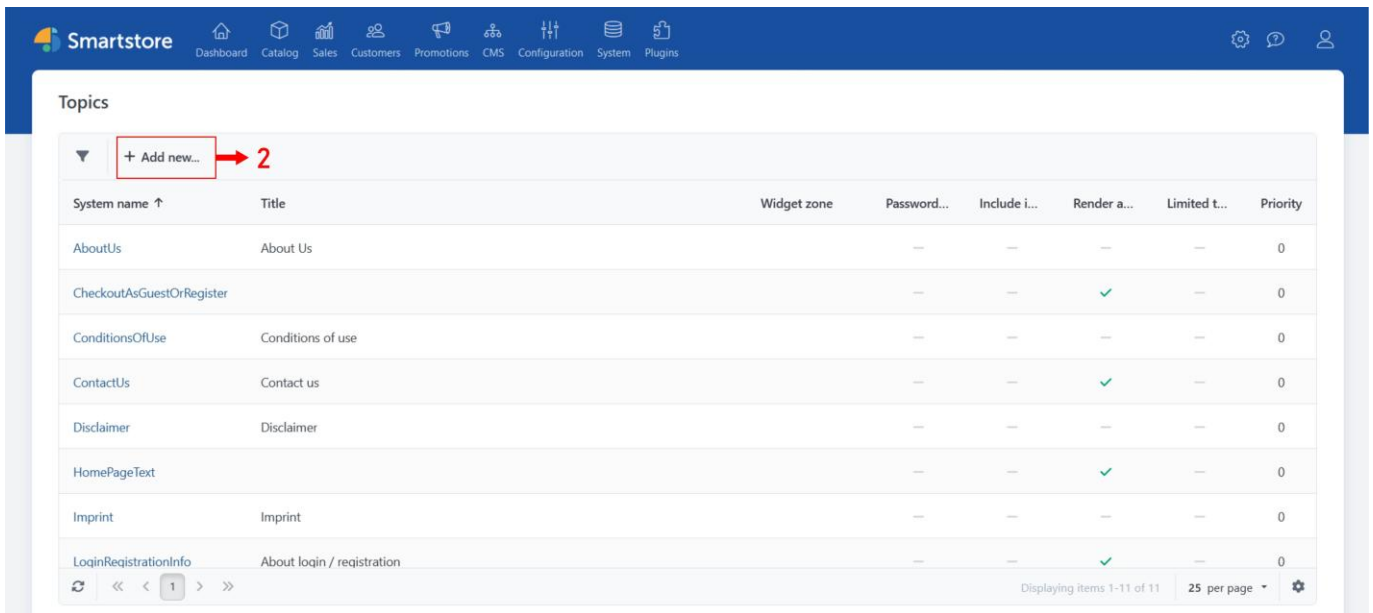
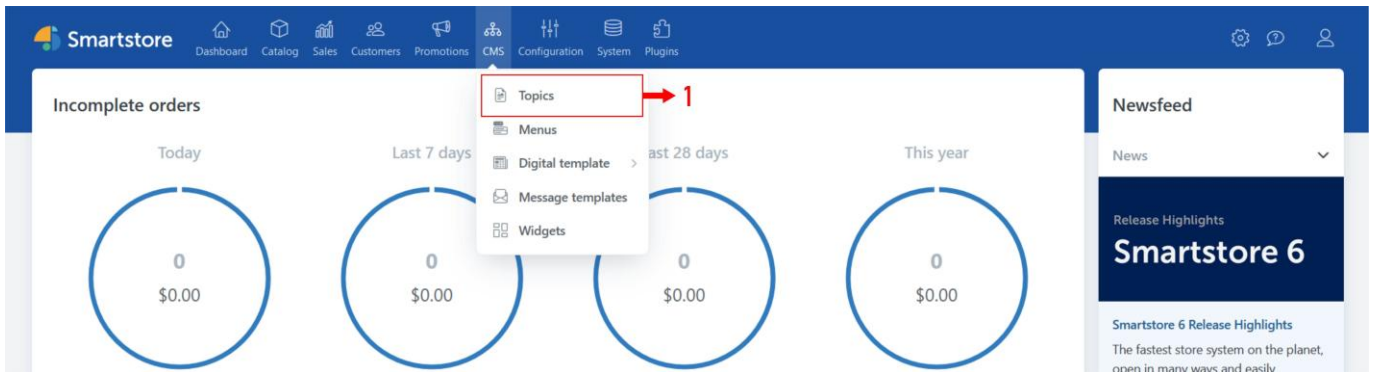

Smartstore Dashboard Catalog Sales Customers Promotions CMS Configuration System Plugins

← Edit topic details - HomePageText Save Save and Continue Edit Delete

General Search engines (SEO) Attributes

System name: HomePageText → 3

Published: → 4

Priority: 0

Password protected:

Include in sitemap:

Limited to stores: All stores

Limited to customer roles: All customer roles

URL: https://digital.smart-plugins.com/homepagetext/

Render as HTML widget:

Html Id:

Body CSS class:

Short title:

Title:

Intro:

Body: 5

Welcome to our specialized watch store!
We are here to provide you with a delightful shopping experience, offering a wide variety of high-quality and stylish watches. From the most classic designs to the most modern styles, you can find any watch you're looking for here in our store. Make your moments even more valuable by choosing your favorite watch.

6. Category Design:

When you add a category, you can display it on the homepage by activating a button.

Smartstore Dashboard Catalog Sales Customers Promotions CMS Configuration System Plugins

Categories → 1

Manage products

Product reviews

Manufacturers

Product tags

Low stock report

Recycle bin

ATTRIBUTES

Product Attributes

Specification Attributes

Checkout Attributes

Incomplete orders Today 0 \$0.00

Orders \$0.00

Newsfeed News

Release Highlights

Smartstore 6

Smartstore 6 Release Highlights

The fastest store system on the planet, open in many ways and easily expandable for any business model: this is the brand new Smartstore 6, the indispensable technological basis for anyone who wants to be at the top of their industry, categories and incredible

Today Yesterday Last 7 days Last 28 days This year

Smartstore Dashboard Catalog Sales Customers Promotions CMS Configuration System Plugins

Manage Categories

+ Add new...

Name	Complete name	Alias	Published	Display order ↑
Classic Watches	Classic Watches		✓	0
Analog Watches	Analog Watches		✓	0
Digital Watches	Digital Watches		✓	0
Dual Time Display	Dual Time Display		✓	0
Basic Smart Watches	Basic Smart Watches		✓	0
Health & Sport Watches	Health & Sport Watches		✓	0
Kids Smartwatch	Kids Smartwatch		✓	0
Kids Wathes	Kids Wathes		✓	0

2. You can choose any category you want to be on the main page

Displaying items 1-18 of 18 25 per page

Smartstore Dashboard Catalog Sales Customers Promotions CMS Configuration System Plugins

Edit category details - Classic Watches

Preview Save Save and Continue Edit Delete

4

3

General

ID: 6

External link: Classic Watches

Parent category: [Unspecified]

Display order: 0

Published:

Show on home page:

Name: Classic Watches

Complete name: Classic Watches

Top description: Click to edit HTML... Show other description

Badge text:

Badge style: Secondary Example

Picture: classic.jpg

However, in addition to this method, you can also use the related module to show the category on the homepage. These two methods differ in design. To add a category using this module, follow the steps below:

The dashboard shows 'Incomplete orders' with three circular gauges for 'Today', 'Last 7 days', and 'This year', all showing \$0.00. A dropdown menu is open from the CMS icon, with 'Category design' highlighted and a red arrow labeled '1' pointing to it.

The dashboard shows a table with a '+ Add new...' button (labeled '2') and a table of category designs. The table has columns for Id, Skin Template, Widget Zone, Category Name, Display Order, Is active, and Limited to stores.

Id	Skin Template	Widget Zone	Category Name	Display Order ↑	Is active	Limited to stores
#2	Default	home_page_after_intro	Classic Watches	0	✓	—
#4	Default	home_page_after_intro	Decorative Clocks	1	✓	—
#3	Default	home_page_after_intro	Smart Watches	2	✓	—
#5	Default	home_page_after_intro	Pocket Watches	3	✓	—
#6	Default	home_page_after_intro	Watch Accessories	4	✓	—

At the bottom right, it says 'Displaying items 1-5 of 5' and '25 per page'.

The 'Category design' configuration form has the following fields and annotations:

- Is active:** A toggle switch that is turned on.
- External Link:** A dropdown menu with 'Classic Watches' selected. A red arrow labeled '3' points to it with the text '3. select your category'.
- Picture:** A field containing an image of a watch and the text 'classic.jpg'. A red arrow labeled '4' points to it with the text '4. select your image'.
- Display Order:** A numeric input field with the value '0'.
- Widget Zone:** A dropdown menu with 'home_page_after_intro' selected. A red arrow labeled '5' points to it with the text '5. Select the area where you want the category design to be placed.'
- Skin Template:** A dropdown menu with 'Default' selected.
- Limited to stores:** A dropdown menu with 'All stores' selected.
- Buttons:** 'Cancel', 'Save' (highlighted with a red box and arrow labeled '6'), 'Save and Continue Edit', and 'Delete'.

7. Multi Item Slider (1):

To create a multi-item slider, follow the steps below:

The first screenshot shows the Smartstore dashboard with the CMS menu open. The 'Multi Item Slider' option is highlighted with a red box and labeled '1'.

The second screenshot shows the widget management table. The '+ Add new...' button is highlighted with a red box and labeled '2'.

Id	Skin Template	Name	Show zone	Display Order ↑	Is active
#18	BgBigHeroImage	fullbackground	home_page_after_best sellers	0	✓
#19	CardThreeItem	threeitem	home_page_after_categories	0	✓
#20	CardTwoItem	twoitem	home_page_after_manufacturers	0	✓

The third screenshot shows the 'Slide details' form. The 'Name' field is highlighted with a red box and labeled '3'. The 'Show zone' dropdown is highlighted with a red box and labeled '4'. The 'Card Three Item' option in the 'Limited to stores' list is highlighted with a red box and labeled '5'. The 'Save and Continue Edit' button is highlighted with a red box and labeled '6'.

4. Select the area where you want the multi-item slider to be placed.

Smartstore Dashboard Catalog Sales Customers Promotions CMS Configuration System Plugins

Slide details Cancel Save Save and Continue Edit Delete

Is active

Name

Display Order

Show zone

Skin Template

Limited to stores

+ Add new... → 7

Id	Image	Display Order ↑	Is active
#3		0	<input checked="" type="checkbox"/>
#4		0	<input checked="" type="checkbox"/>
#5		0	<input checked="" type="checkbox"/>

Displaying items 1-3 of 3 25 per page

Smartstore Dashboard Catalog Sales Customers Promotions CMS Configuration System Plugins

Slide details Cancel Save Save and Continue Edit Delete

Is active

Display Order

Externer Link

Picture → 8. select your image

Tagline

Title → 9. Write your title, tagline, intro or text.

Intro

Text

Display button → 10. Add your button

Limited to stores

→ you can link your image or connect it to a category.

11

The size of the images used in this multi-item slider are as follows:

Smaller images: 650 * 550 pixels

Larger images: 650 * 620 pixels.

8. Product:

To add a product, use the link below:

<https://smartstore.atlassian.net/wiki/spaces/SMNET50/pages/1956119693/Managing+Products>

9. Multi Item Slider (2):

To create a multi-item slider, follow the steps below:

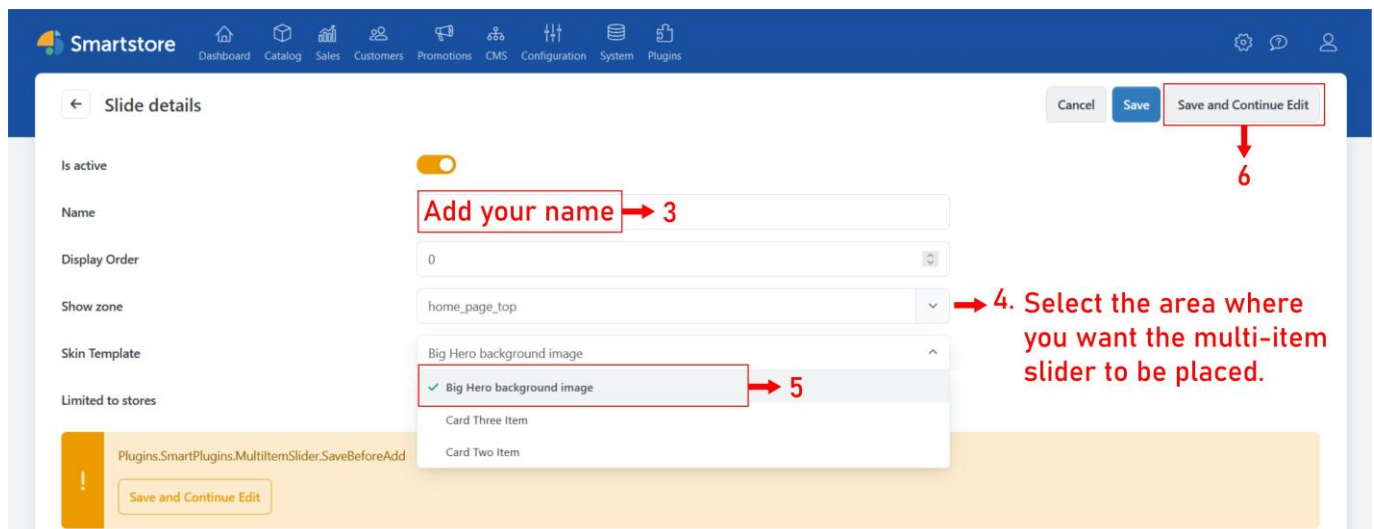
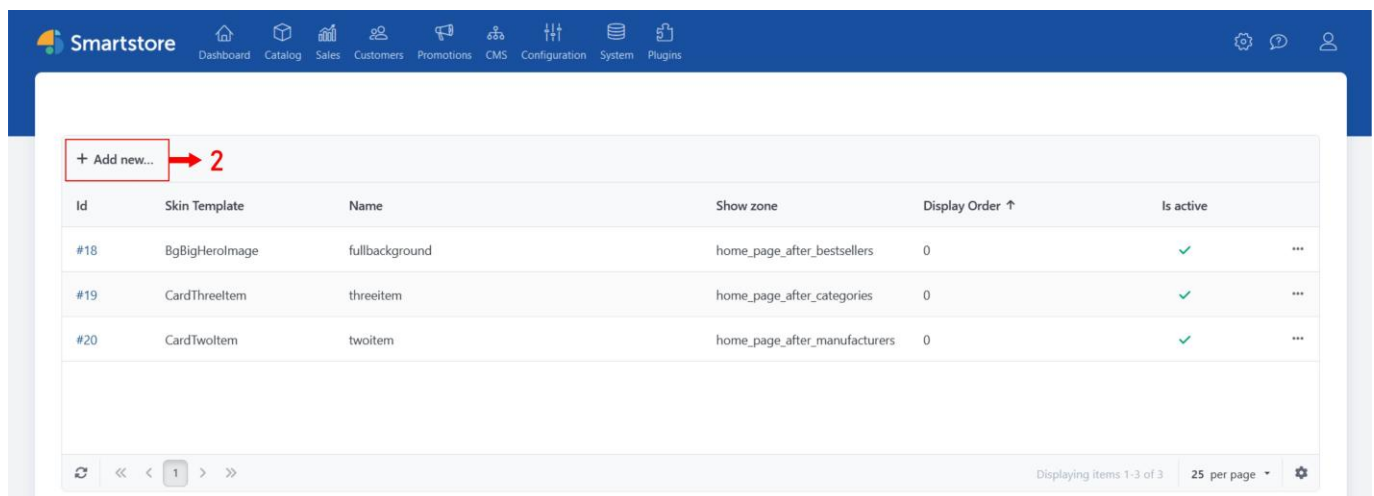
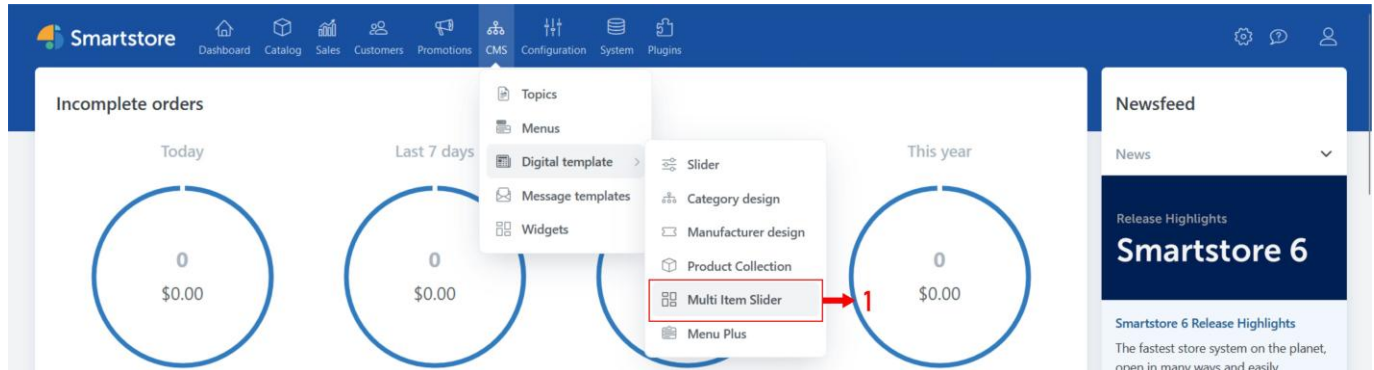

Smartstore Dashboard Catalog Sales Customers Promotions CMS Configuration System Plugins

Slide details Cancel Save Save and Continue Edit Delete

Is active

Name fullbackground

Display Order 0

Show zone home_page_after_best sellers

Skin Template Big Hero background image

Limited to stores All stores

+ Add new... → 7

Id	Display Order ↑	Is active
#2	0	✓

Smartstore Dashboard Catalog Sales Customers Promotions CMS Configuration System Plugins

Slide details Cancel Save Save and Continue Edit Delete

Is active

Display Order 0

Externe Link

Picture × → 8. select your image

Tagline Timeless Elegance, Affordable Prices

Title Discover the Perfect Watch for Every Style

Intro Your One-Stop Shop for Quality and Value → 9. Write your title, tagline, intro or text.

Text At our store, you'll find a wide range of watches to suit every taste and budget. From classic designs to modern trends, we offer the best prices without compromising on quality.

Display button → 10. Add your button

Limited to stores All stores

→ you can link your image or connect it to a category.

The size of the images used in this multi item slider is 1920 * 600 pixels.

10. Product Collection:

To add a product collection, follow the steps below:

The image shows two screenshots from the Smartstore CMS interface. The top screenshot displays the dashboard with a menu open over the 'Incomplete orders' widget. The 'Product Collection' option is highlighted in the menu, with a red arrow labeled '1' pointing to it. The bottom screenshot shows the 'Add new...' button highlighted with a red box and a red arrow labeled '2' pointing to it. Below the button is a table listing existing widgets.

Id ↑	Skin Template	Name	Widget Zone	Display Order	Is Active	Limited to stores
# 7	RightImage		home_page_after_manufacturers	0	✓	—
# 17	LeftImage		home_page_after_manufacturers	0	✓	—

At the bottom of the table, there is a pagination control showing '1' and a footer indicating 'Displaying items 1-2 of 2' and '25 per page'.

Smartstore Dashboard Catalog Sales Customers Promotions CMS Configuration System Plugins **12**

Product collection details Cancel Save Save and Continue Edit Delete

Name **3. write your name**

Type of product selection **4. Choose the type in which you want the products to be displayed from that section.**

Products **5. select your product**

Title **6. write your title**

Max Items **7. select number of items**

Autoplay Enabled **8. select If you want it to autoplay**

Is Active

Display Order

Picture Id  **9. select your image**

Widget Zone **10. select your area**

Skin Template

Limited to stores

Plugins.SmartStore.PageBuilder.ProductList.ProductProperties

Short description

Price

Ratings

Brands

Dimensions

Delivery time

Attributes **11. More settings**

Legal information

Action buttons

Badges

Sku

Weight

The size of the images used in the product collection of this template is 666 * 666 pixels.

11. Product Collection:

To add a product collection, follow the steps below:

The image shows two screenshots from the Smartstore CMS interface. The top screenshot shows the 'Incomplete orders' dashboard with a dropdown menu open over the 'This year' widget. The 'Product Collection' option is highlighted in the menu, with a red arrow pointing to it labeled '1'. The bottom screenshot shows the 'Add new...' button highlighted with a red box and a red arrow labeled '2', pointing to the 'Product Collection' widget in a list of available widgets.

Id ↑	Skin Template	Name	Widget Zone	Display Order	Is Active	Limited to stores
# 7	RightImage		home_page_after_manufacturers	0	✓	—
# 17	LeftImage		home_page_after_manufacturers	0	✓	—

Displaying items 1-2 of 2 | 25 per page

Smartstore Dashboard Catalog Sales Customers Promotions CMS Configuration System Plugins **12**

Product collection details Cancel Save Save and Continue Edit Delete

Name **3. write your name**

Type of product selection **4. Choose the type in which you want the products to be displayed from that section.**

Products **5. select your product**

Title **6. write your title**

Max Items **7. select number of items**

Autoplay Enabled **8. select If you want it to autoplay**

Is Active

Display Order

Picture Id  **9. select your image**

Widget Zone **10. select your area**

Skin Template

Limited to stores

Plugins.SmartStore.PageBuilder.ProductList.ProductProperties

Short description

Price

Ratings

Brands

Dimensions

Delivery time

Attributes **11. More settings**

Legal information

Action buttons

Badges

Sku

Weight

The size of the images used in the product collection of this template is 666 * 666 pixels.

12. Multi Item Slider (3):

To create a multi-item slider, follow the steps below:

The first screenshot shows the Smartstore dashboard with the CMS menu open. The 'Multi Item Slider' option is highlighted with a red box and labeled '1'.

The second screenshot shows the 'Add new...' button highlighted with a red box and labeled '2'. Below it is a table of existing widgets:

Id	Skin Template	Name	Show zone	Display Order ↑	Is active
#18	BgBigHeroImage	fullbackground	home_page_after_best sellers	0	✓
#19	CardThreeItem	threeitem	home_page_after_categories	0	✓
#20	CardTwoItem	twoitem	home_page_after_manufacturers	0	✓

The third screenshot shows the 'Slide details' form. The 'Name' field is highlighted with a red box and labeled '3'. The 'Show zone' dropdown is highlighted with a red box and labeled '4'. The 'Card Two Item' option in the 'Skin Template' dropdown is highlighted with a red box and labeled '5'. The 'Save and Continue Edit' button at the top right is highlighted with a red box and labeled '6'.

Smartstore Dashboard Catalog Sales Customers Promotions CMS Configuration System Plugins

Slide details

Cancel Save Save and Continue Edit Delete

Is active

Name twoitem

Display Order 0

Show zone home_page_after_manufacturers

Skin Template Card Two Item

Limited to stores All stores

+ Add new... → 7

Id	Display Order ↑	Is active
#6	0	✓
#7	0	✓

Smartstore Dashboard Catalog Sales Customers Promotions CMS Configuration System Plugins

Slide details

Cancel Save Save and Continue Edit Delete

Is active

Display Order 0

Externe Link → you can link your image or connect it to a category.

Picture e975ac41d3.png × → 8. select your image

Tagline

Title MEN'S COLLECTION → 9. Write your title, tagline, intro or text.

Intro

Text Click to edit HTML...

Display button → 10. Add your button

Limited to stores All stores

The size of the images used in this multi-item slider are as follows:

Smaller images: 800 * 600 pixels

Larger images: 1000 * 970 pixels.

13. Manufacturer Design:

To add a manufacturer, follow these steps:

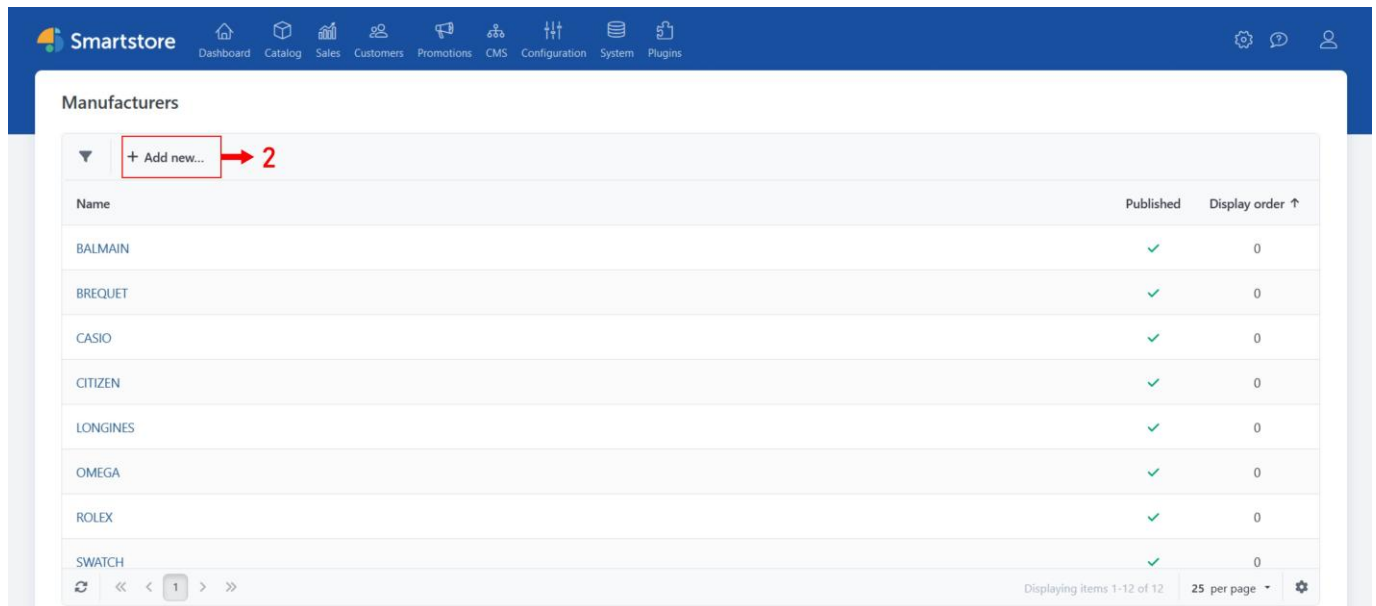
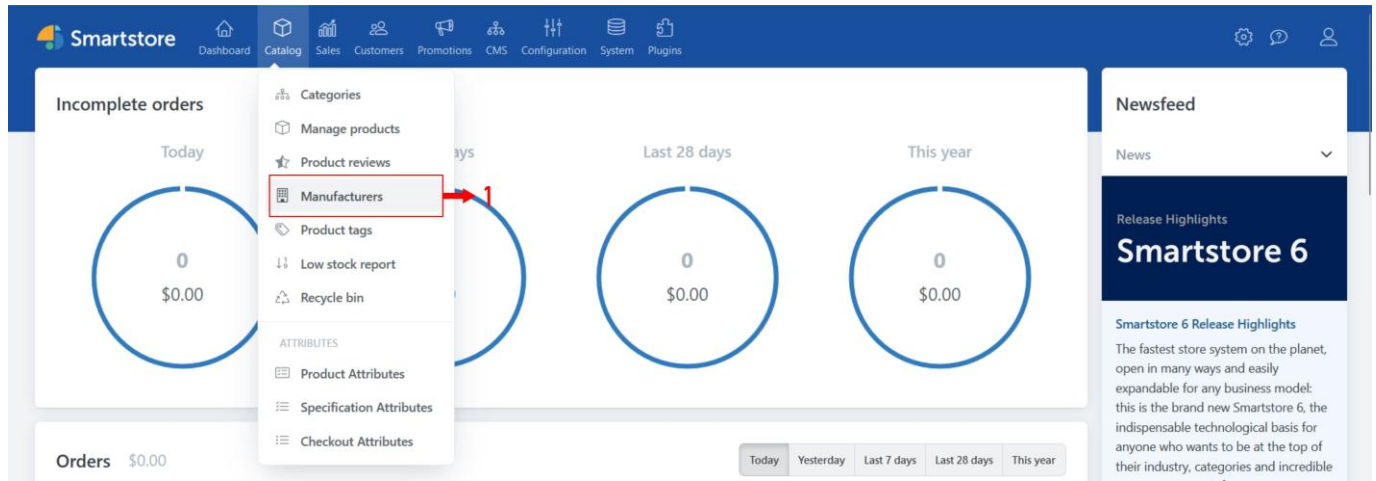

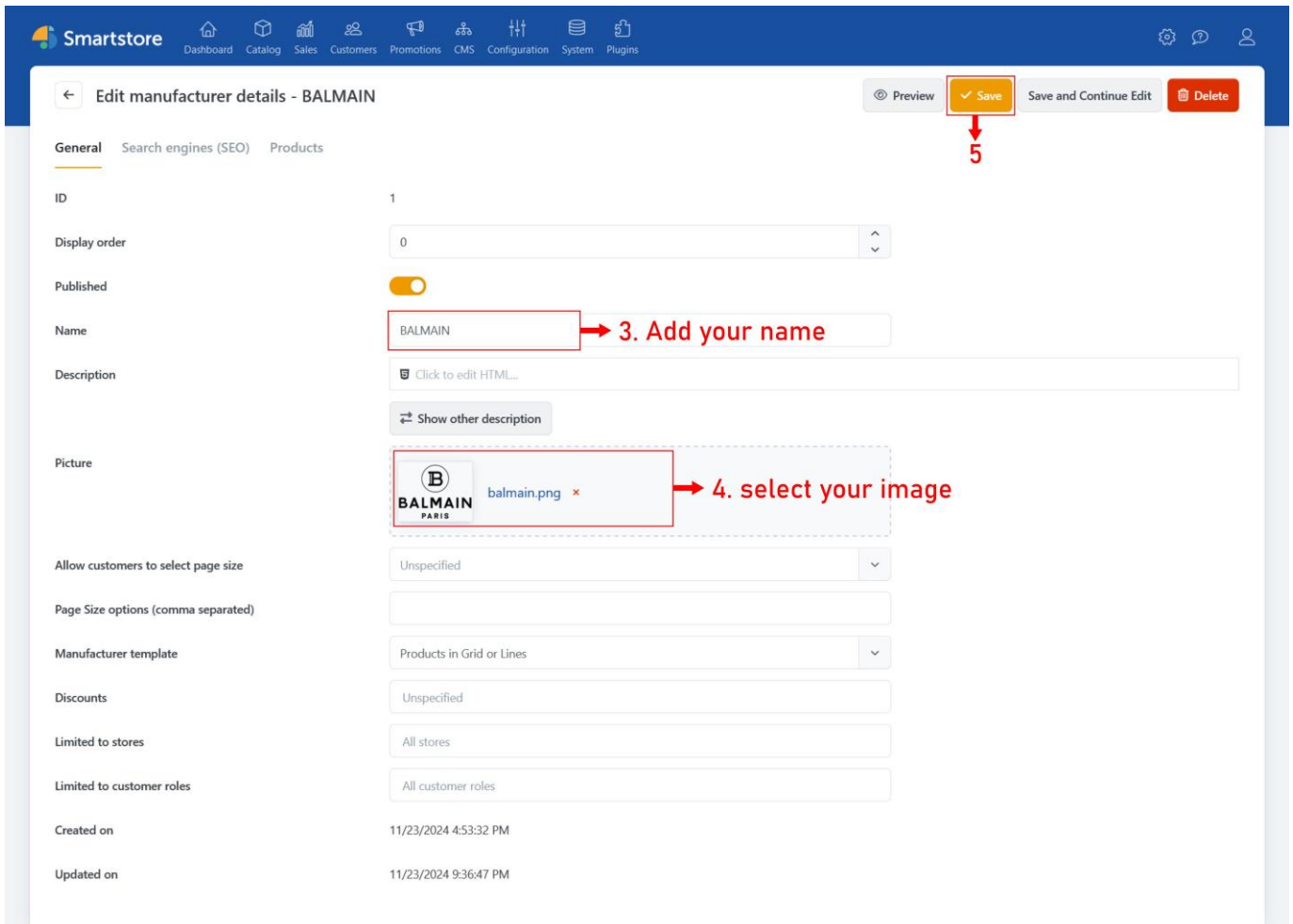

When you add manufacturers, they will automatically appear on the main page of your template.

However, if you want the manufacturers to be displayed using the manufacturer module, you need to disable the previous display. To disable the previous display, follow these steps:

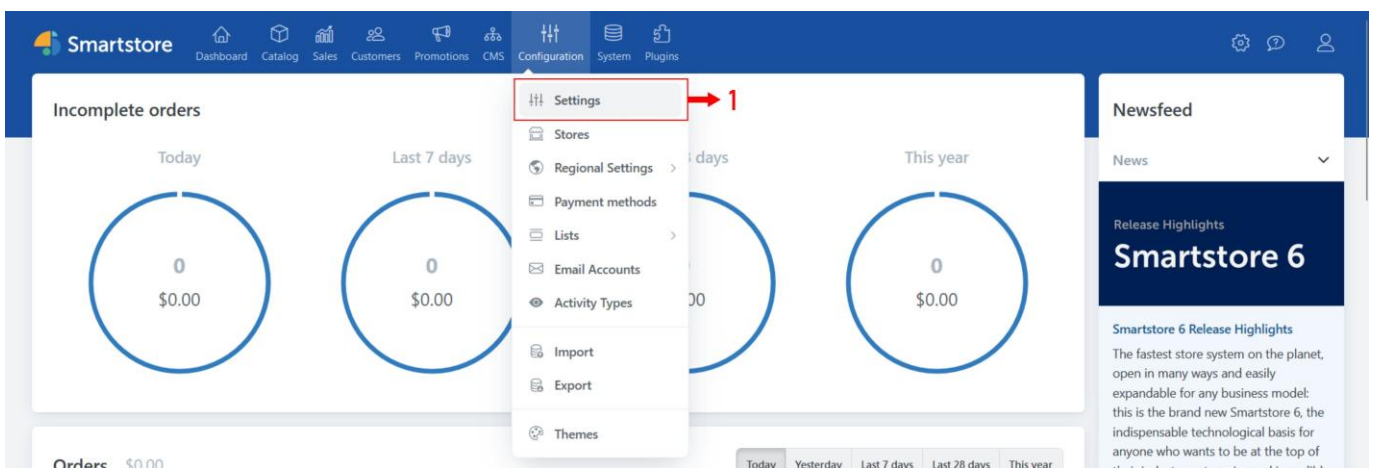

Smartstore Dashboard Catalog Sales Customers Promotions CMS Configuration System Plugins

General settings

Save

General SEO Security Localization PDF Company Contact data Social networks

Catalog → 2

Store closed

DateTime settings

Default store time zone (UTC+03:30) Tehran

Allow customers to select time zone

Email Accounts

Default email account Store name (test@mail.com)

Smartstore Dashboard Catalog Sales Customers Promotions CMS Configuration System Plugins

Catalog settings

Save

General Product lists Product detail Customers **Manufacturers** Prices

Display manufacturers on homepage → 4

Amount of manufacturers to display on homepage 18

Display manufacturers in offcanvas menu

Amount of manufacturers to display in offcanvas menu 0

Display manufacturer pictures in lists

Hide default picture for manufacturers

Sort manufacturers alphabetically

3

Smartstore Dashboard Catalog Sales Customers Promotions CMS Configuration System Plugins

Catalog settings

Save

General Product lists Product detail Customers **Manufacturers** Prices

Display manufacturers on homepage ←

Display manufacturers in offcanvas menu

Amount of manufacturers to display in offcanvas menu 0

Display manufacturer pictures in lists

Hide default picture for manufacturers

Sort manufacturers alphabetically

5

Now, to add manufacturers using the manufacturer display module, follow these steps:

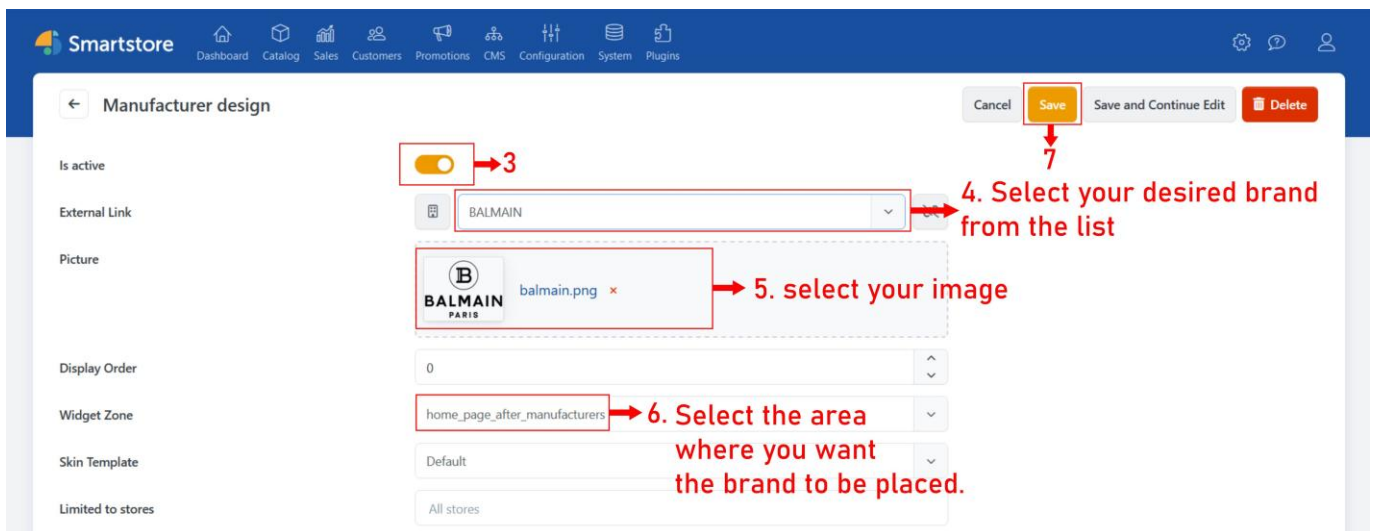
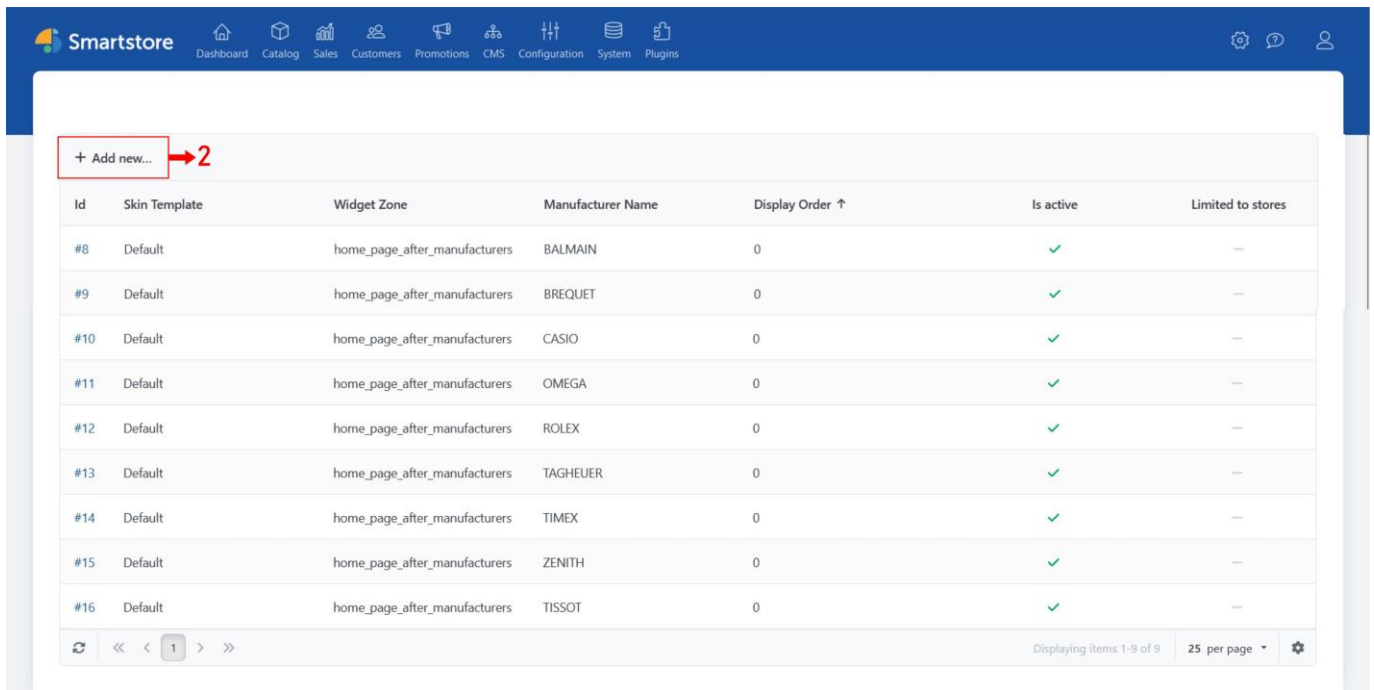
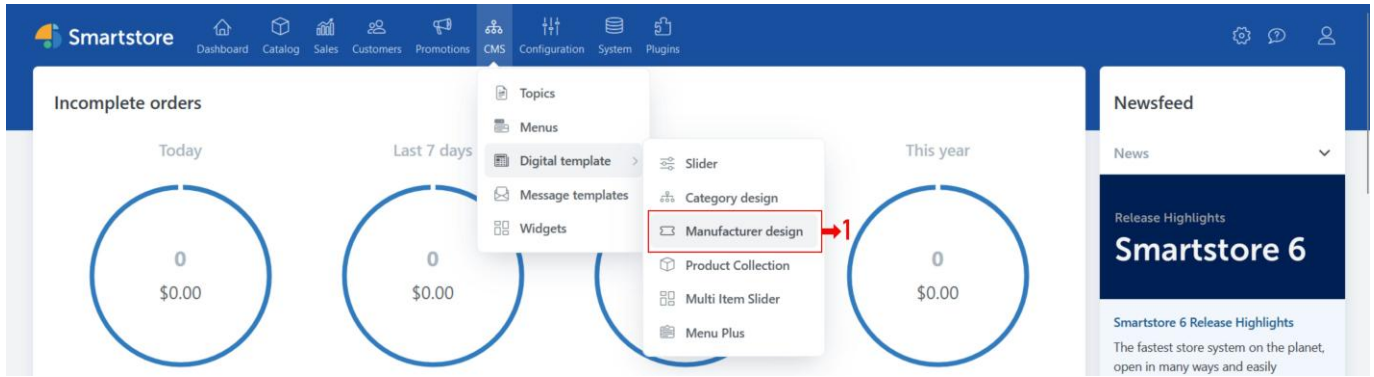

14. Slider (2):

This step is the same as Step 4.

The size of the images used in the slider of this template is 1920 * 320 pixels.

15. Recently Viewed Product:

This section will be displayed when you view the products in your store.

16. Social Media:

In this section, you can place the links to the social media pages.

